

Flanged Locating Pins/Height Adjusting Blocks

-Flat Type-

CAD Data Folder Name: Locating_Pins
* All prices are in SS and subjected to change without prior notice

Flanged Locating Pins Flat Type



RoHS

| Round Flanged | Compact Flange | Material | Surface Treatment |
|---------------|----------------|----------|--|
| MASA | MATA | MATA | SKS3 |
| MASD | MATD | MATD | SKS3 |
| SMASA | SMATA | SMATA | SUS304 |
| SMASD | SMATD | SMATD | SUS304 |
| HMASA | HMATA | HMATA | SUS304 |
| HMASD | HMATD | HMATD | SUS304 |
| CMASA | CMATA | CMATA | SUS440 Equivalent |
| | | | Hard Chrome Plating (Depth: 0.02mm, Max. 0.1mm) |
| | | | Plating Hardness 750HV~ |
| | | | Hardening Hardness 50~55HRC |

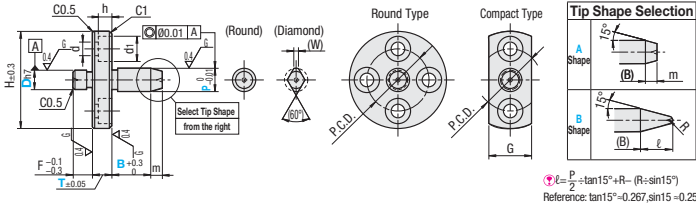

Tip Shape Selection
 $\phi = \frac{P}{2} \tan 15^\circ + R - (R \sin 15^\circ)$
 Reference: $\tan 15^\circ = 0.267, \sin 15^\circ = 0.259$

| Part Number | Type | Tip Shape | D | P | B | T | F | H | G | P.C.D. | d | d1 | h | m | R | (W) |
|---------------|-----------------|-----------|--------|-------------|----------|-----------|----------|----|----|--------|-----|-----|-----|-----|---|-----|
| Round Flanged | Compact Flanges | A | 5 | 0 | 3.0-5.00 | 3.0-10.0 | 5.0-10.0 | 5 | 25 | 11 | 16 | 3.5 | 6.5 | 3.5 | 3 | 1.5 |
| MASA | MATA | 6 | -0.012 | 4.00-7.00 | 3.0-12.0 | 7.0-15.0 | 5 | 36 | 16 | 24 | 5.5 | 9.5 | 5.5 | 4 | 2 | 3 |
| MASD | MATD | 8 | 0 | 6.00-9.00 | 3.0-15.0 | 11.0-20.0 | 10 | 54 | 24 | 37 | 9 | 14 | 9 | 5 | 4 | 4 |
| SMASA | SMATA | 10 | -0.015 | 7.00-11.00 | 4.0-20.0 | | | | | | | | | | | |
| SMASD | SMATD | 12 | 0 | 8.00-12.00 | 4.0-20.0 | | | | | | | | | | | |
| HMASA | HMATA | 16 | -0.018 | 13.00-16.00 | 5.0-20.0 | | | | | | | | | | | |
| HMASD | HMATD | 20 | -0.021 | 16.00-20.00 | 5.0-20.0 | | | | | | | | | | | |
| CMASA | CMATA | | | | | | | | | | | | | | | |
| CMASD | CMATD | | | | | | | | | | | | | | | |

Round Flanged

| D | MASA | SMASA | HMASA | CMASA | MASD | SMASD | HMASD | CMASD |
|----|-------|-------|--------|--------|-------|--------|--------|--------|
| 5 | 63.37 | 75.41 | 88.08 | 82.31 | 69.63 | 82.95 | 96.91 | 90.49 |
| 6 | 65.46 | 77.97 | 91.13 | 85.03 | 75.25 | 89.53 | 104.77 | 97.87 |
| 8 | 67.71 | 80.54 | 94.34 | 88.08 | 77.81 | 92.73 | 108.46 | 101.24 |
| 10 | 70.11 | 83.43 | 97.55 | 91.13 | 80.54 | 95.94 | 112.15 | 104.77 |
| 12 | 72.52 | 86.32 | 100.92 | 94.18 | 83.43 | 99.15 | 116.16 | 108.46 |
| 16 | 75.09 | 89.20 | 104.45 | 97.55 | 86.32 | 102.68 | 120.17 | 112.15 |
| 20 | 78.78 | 93.70 | 109.74 | 102.36 | 90.65 | 107.82 | 126.11 | 117.76 |

Compact Flange

| D | MATA | SMATA | HMATATA | CMATA | MATD | SMATD | HMATD | CMATD |
|----|-------|--------|---------|--------|-------|--------|--------|--------|
| 8 | 73.16 | 86.96 | 101.88 | 95.14 | 84.07 | 100.11 | 117.12 | 109.42 |
| 10 | 75.73 | 90.01 | 105.41 | 98.35 | 86.96 | 103.48 | 121.13 | 113.11 |
| 12 | 78.29 | 93.22 | 108.94 | 101.72 | 90.01 | 107.17 | 125.30 | 117.12 |
| 16 | 81.02 | 96.42 | 112.79 | 105.25 | 93.22 | 110.86 | 129.80 | 121.13 |
| 20 | 85.03 | 101.24 | 118.40 | 110.54 | 97.87 | 116.48 | 136.21 | 127.23 |

* For Compact Flanged Type, D Dimension 5 - 6 are not applicable.

Order Example: Part Number - P - B - T
 MASAA8 - P6.50 - B7.5 - T8.2

Alteration: Part Number - L - (EAK)
 KKB15 - EAK2

Volume Discount Rate: Round down to the nearest one cent. P91

| Quantity | 1-10 | 11-20 |
|----------|------|-------|
| Rate | 5% | 5% |

Express B: \$812.84/piece P.92
 P.92: A flat charge of \$534.66 for 3 or more identical pieces.

Height Adjusting Blocks



RoHS

Standard Type

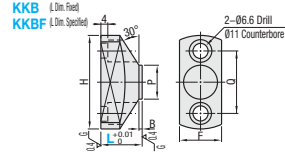

Coolant Hole Type

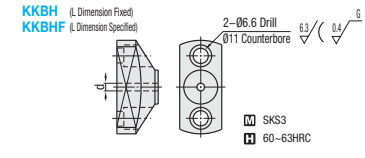

L Dimension Fixed

| Part Number | L | P | B | H | Q | F | d | Unit Price Qty. 1-4 |
|-------------|----|----|---|----|----|----|---|---------------------|
| KKB | 15 | 20 | 2 | 50 | 36 | 22 | 5 | 67.38 |
| KKBH | 25 | | | | | | | 72.36 |
| | | | | | | | | 68.83 |
| | | | | | | | | 73.80 |
| | | | | | | | | 71.40 |
| | | | | | | | | 76.21 |

L Dimension Specified

| Part Number | L | P | B | H | Q | F | d | Unit Price Qty. 1-4 |
|-------------|-------|----|---|----|----|----|---|---------------------|
| KKBF | 16-20 | 20 | 2 | 50 | 36 | 22 | 5 | 75.73 |
| KKBHF | 21-25 | | | | | | | 81.18 |
| | | | | | | | | 78.46 |
| | | | | | | | | 83.91 |

Order Example: Part Number - L
 KKB15 - L21

Days to Ship: 5 Days
 Express A: \$88.02/piece P.92
 P.92: A flat charge of \$521.66 for 3 or more identical pieces.

L Dimension Specified: 7 Days
 Express B: \$88.02/piece P.92
 P.92: A flat charge of \$521.66 for 3 or more identical pieces.

Volume Discount Rate: Round down to the nearest one cent. P91

| Quantity | 1-4 | 5-9 | 10-19 | 20-29 |
|----------|-----|-----|-------|-------|
| Rate | | 5% | 10% | 15% |

* For orders larger than indicated values, please request for quotation.

Alteration: Part Number - L - (EAK)
 KKB15 - EAK2

Days to Ship: 7 Days
 Express B: \$82.02/piece P.92
 P.92: A flat charge of \$521.66 for 3 or more identical pieces.

Alteration Code: Seating Sensor Holes EAK

Spec.:

Ordering Code:
 EAK1 1.5
 EAK1.5 1.5
 EAK2 2

* Not applicable to Coolant Hole Type

Price Adder: 11.23

Flanged Locating Pins

-Mounting Type-

CAD Data Folder Name: Locating_Pins
* All prices are in SS and subjected to change without prior notice



RoHS

| Standard | Compact | Stepped | Shape | Flange |
|----------|---------|---------|---------|---------|
| FLPAC | FSPAC | - | Round | Round |
| FLPDC | FSPDC | - | Diamond | Round |
| FLPAQ | FSPAQ | FHPAQ | Round | Round |
| FLPDQ | FSPDQ | FHPDQ | Diamond | Compact |

SCM415
 Carburized
 55HRC - (Depth 0.7-0.8)

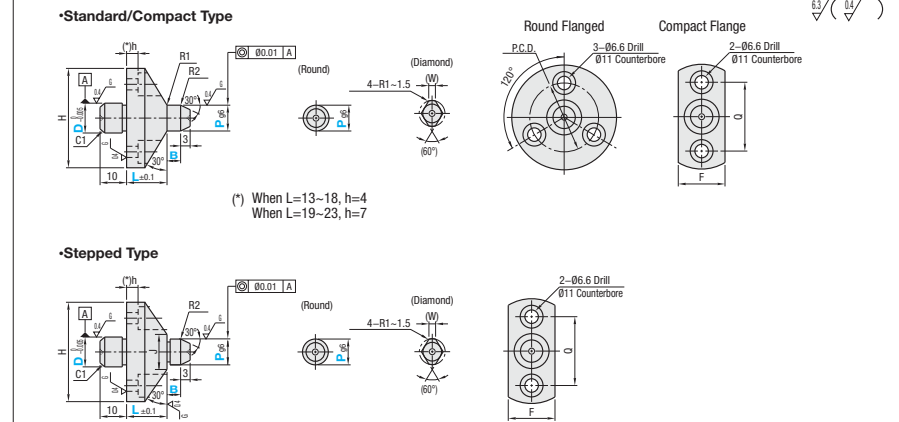

* The head of fixing bolt may project out of the flange surface depending on dimensions.

Standard Type

| Part Number | L | P | B | H | P.C.D. | Q | (W) | F | Unit Price Qty. 1-4 |
|-------------|----|-------|-------------|-----|--------|----|-----|-----|---------------------|
| FLPAC | 10 | 15-23 | 6.00-13.00 | 3-7 | 44 | 30 | 30 | 2.5 | 21 |
| FLPDC | 12 | | 13.00-16.00 | | 48 | 33 | 33 | 4 | 24 |
| FLPAQ | 16 | | 16.00-20.00 | | 56 | 41 | 41 | 5 | 28 |
| FLPDQ | | | | | | | | | |
| | | | | | | | | | 84.87 |
| | | | | | | | | | 95.94 |
| | | | | | | | | | 100.76 |
| | | | | | | | | | 111.83 |

Compact Type

| Part Number | L | P | B | H | P.C.D. | Q | (W) | F | Unit Price Qty. 1-4 |
|-------------|----|-------|-------------|-----|--------|----|-----|-----|---------------------|
| FSPAC | 12 | 13-23 | 6.00-13.00 | 3-7 | 38 | 25 | 25 | 2.5 | 17 |
| FSPDC | 16 | | 13.00-16.00 | | 42 | 29 | 29 | 4 | 21 |
| FSPAQ | 20 | | 16.00-20.00 | | 46 | 33 | 33 | 5 | 25 |
| FSPDQ | | | | | | | | | |
| | | | | | | | | | 76.05 |
| | | | | | | | | | 87.92 |
| | | | | | | | | | 90.81 |
| | | | | | | | | | 102.68 |

Stepped Type

| Part Number | L | P | B | J | H | Q | (W) | F | Unit Price Qty. 1-4 |
|-------------|----|-------|-------------|-----|----|----|-----|-----|---------------------|
| FHPAQ | 10 | 15-23 | 6.00-13.00 | 3-7 | 17 | 44 | 30 | 2.5 | 21 |
| FHPDQ | 12 | | 13.00-16.00 | | 19 | 48 | 33 | 4 | 24 |
| | 16 | | 16.00-20.00 | | 28 | 56 | 41 | 5 | 28 |
| | | | | | | | | | |
| | | | | | | | | | 105.73 |
| | | | | | | | | | 117.44 |
| | | | | | | | | | 108.78 |
| | | | | | | | | | 121.29 |
| | | | | | | | | | 117.92 |
| | | | | | | | | | 131.40 |

Order Example: Part Number - L - P - B
 FLPAC12 - L18 - P14.25 - B7

Days to Ship: 7 Days
 Express B: \$82.02/piece P.92
 P.92: A flat charge of \$521.66 for 3 or more identical pieces.

Alterations: Part Number - L - P - B - (KC)
 FLPAC12 - L18 - P14.25 - B7 - KC

Days to Ship: 7 Days

Alteration Code: Compact Flanged Type Diamond Direction KC

Spec.:

Changes the diamond angle to 90° from the standard position 0°.
 * Applicable to Compact Flanged Type only

Price Adder: 4.81

Volume Discount Rate: Round down to the nearest one cent. P91

| Quantity | 1-4 | 5-9 | 10-19 | 20-29 |
|----------|-----|-----|-------|-------|
| Rate | | 5% | 10% | 15% |

* For orders larger than indicated values, please request for quotation.