

Locating Pins Small Head Round Tapered

■ Features: Insertion and extraction are easier compared to the Tapered Type due to the radiuses on connecting section.

When ordering, select Part Number and Values from Selection Steps ①~③.

Ordering Example	Part Number (①Type · ②D)	-	③P
	JPRSB10	-	6
	CJPRSPB12	-	8



Type		Material	Surface Treatment	Hardness
JPRSB	JPRSPB	SKS3 Equivalent	-	Treated Hardness: 60 ~ 63HRC
GJPRSB	GJPRSPB	SKS3 Equivalent	Hard Chrome Plating Plating Thickness: 3µm or More	Treated Hardness: 60 ~ 63HRC Plating Hardness: 750HV ~
CJPRSB	CJPRSPB	SUS440C Equivalent	-	Treated Hardness: 50 ~ 55HRC
SJPRSB	SJPRSPB	SUS304 Equivalent	-	-

D Dim. Tolerance

D	m6	p6
3	+0.008 +0.002	+0.012 +0.006
4	+0.012 +0.004	+0.020 +0.012
6	+0.015 +0.006	+0.024 +0.015
8	+0.015 +0.006	+0.024 +0.015
10	+0.015 +0.006	+0.024 +0.015
12	+0.018 +0.007	+0.029 +0.018
13	+0.018 +0.007	+0.029 +0.018
16	+0.021 +0.008	+0.035 +0.022

④ SUS440C Equivalent has an identification groove on D part.
⑤ Ground SUS304 Equivalent may not have the centering holes.

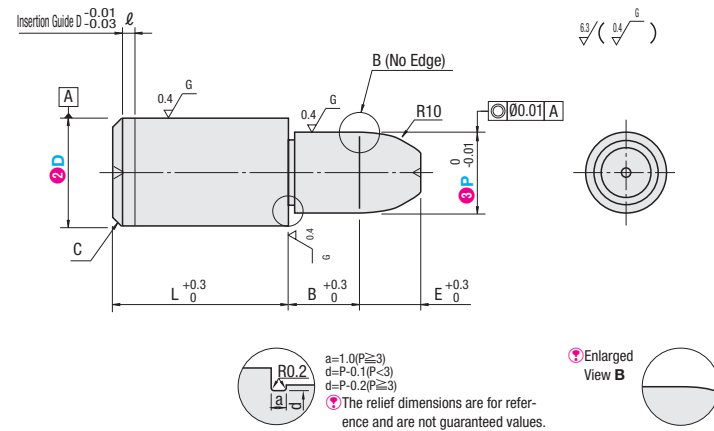

Part Number		③P	L	B	E	ℓ	C
①Type	②D						
<m6> JPRSB GJPRSB CJPRSB SJPRSB	3	2 3	5	3	3	1	0.5
	4	2 3 4	5	3	3	1	1
	5	2 3 4 5	10	5	4	1	1
	6	3 4 5 6	10	5	5	1	1
	8	4 5 6 8	15	6	5	1	1.5
	10	6 8 10	15	8	5	1	2
	12	8 10 12	15	8	6	1	2
	13	12 13	22	8	6	2	2
	16	12 13 14 15 16	22	10	7	2	3
	20	15 16 20	30	10	7	2	3

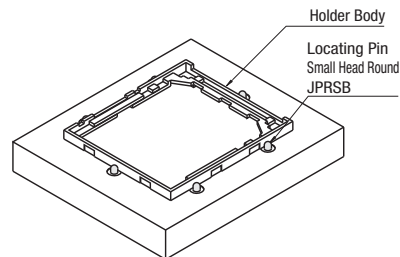

Alterations	Under Neck Radius Alteration	
	Spec.	For detail of machining and Ordering Code, see the WEB Catalog.

Locating Pins Small Head Round Tapered

- D and P Tolerance / Taper R Selectable -

■ Features: Dimensions of Small Head Tapered Type are freely configurable. Tolerances of both ends and taper dimensions are also configurable.

When ordering, select Part Number and Values from Selection Steps ①~⑨.

Ordering Example	Part Number (①Type · ②D Tolerance · ③P Tolerance · ④D)	-	⑤P	-	⑥L	-	⑦B	-	⑧E	-	⑨R
	KFPSAMS16	-	P12.00	-	L14	-	B4.0	-	E5.0	-	R15
	SKFPSAMS12	-	P7.00	-	L10	-	B3.0	-	E4.0	-	R15



Type	Material	Surface Treatment	Hardness
KFPSA	SKS3 Equivalent	-	Treated Hardness: 60 ~ 63HRC
GKFPSA	SKS3 Equivalent	Hard Chrome Plating Plating Thickness: 3µm or More	Treated Hardness: 60 ~ 63HRC Plating Hardness: 750HV ~
CKFPSA	SUS440C Equivalent	-	Treated Hardness: 50 ~ 55HRC
SKFPSA	SUS304 Equivalent	-	-

Tolerance Selection

D or P	②④D and P Tolerance				
	M	P	G	H	S
2.00~3.00	+0.008 +0.002	+0.012 +0.006	-0.002 -0.008	0 -0.010	0 -0.01
3.01~6.00	+0.012 +0.004	+0.020 +0.012	-0.004 -0.012	0 -0.012	
6.01~10.00	+0.015 +0.006	+0.024 +0.015	-0.005 -0.014	0 -0.015	
10.01~18.00	+0.018 +0.007	+0.029 +0.018	-0.006 -0.017	0 -0.018	
18.01~20.00	+0.021 +0.008	+0.035 +0.022	-0.007 -0.020	0 -0.021	

④ SUS440C Equivalent has an identification groove on D part.

⑤ When D=P, there will be no relief.

(i) When D=P and tolerances are different

(ii) When D=P and tolerances are the same

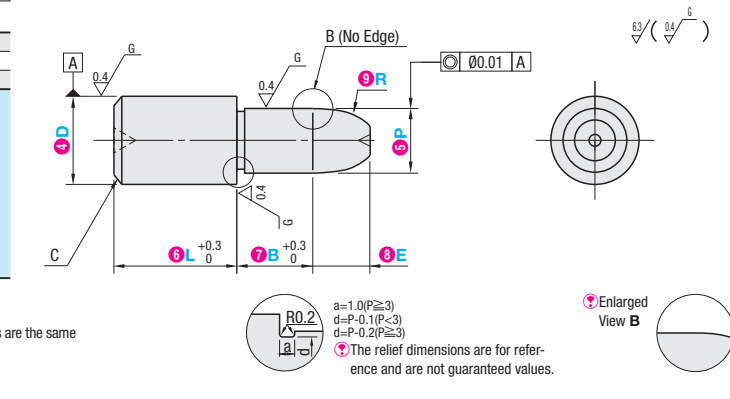
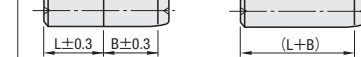

Part Number		⑤P Configurable Unit 0.01mm	⑥L Configurable Unit 1mm	⑦B 0.5mm Increment	⑧E 0.5mm Increment	⑨R Selection	C	
①Type	②D Tolerance Selection							
KFPSA GKFPSA CKFPSA SKFPSA	M P G H	P G H S	3	2.00~3.00	3~8	2.0~10.0	1.0~15.0	5
			4	2.00~4.00	4~12	2.0~10.0		10
			5	2.00~5.00	5~12	2.0~10.0		15
			6	2.00~6.00	5~12	3.0~12.0		20
			8	3.00~8.00	8~15	3.0~14.0		25
			10	3.00~10.00	8~15	3.0~16.0		30
			12	5.00~12.00	10~18	3.0~18.0		
			13	6.00~13.00	12~20	3.0~20.0		
			16	10.00~16.00	14~25	3.0~20.0		
			20	13.00~20.00	18~32	3.0~20.0		

④ Specifiable value depends on P dimension. Confirm "Details of E Dimension and R Dimension Range" in the table.

Details of E and R Dimension Range

P Configurable Unit 0.01mm	E Configurable Unit 0.5mm	R Selection
2.00~4.00	1.0~2.0	5 10
4.01~8.00	2.5~4.0	10 15
8.01~12.00	4.5~7.0	10 15 20
12.01~16.00	5.0~10.0	15 20 25
16.01~20.00	5.0~15.0	20 25 30

Alterations	Insertion Guide Machining / Under Neck Radius Alteration / Air Vent			
	Spec.	For detail of machining and Ordering Code, see the WEB Catalog.		

Locating Pins Small Head Round Tapered

■ Features: Configured to mount with a screw from the bottom of the Large Head Tapered Type. Improved maintainability compared to press-fit type.

When ordering, select Part Number and Values from Selection Steps ①~③.

Ordering Example: Part Number (①Type · ②No.) - ③P
JPRSTB8 - 8



Type Internal Thread	Material	Surface Treatment	Hardness
JPRSTB	SKS3 Equivalent	-	Treated Hardness: 60 ~ 63HRC
GJPRSTB	SKS3 Equivalent	Hard Chrome Plating Plating Thickness: 3μm or More	Treated Hardness: 60 ~ 63HRC Plating Hardness: 750HV ~
CJPRSTB	SUS440C Equivalent	-	Treated Hardness: 50 ~ 55HRC
SJPRSTB	SUS304 Equivalent	-	-

D Dim. Tolerance

No.	D	g6
6, 6T	6	-0.004 -0.012
8, 8T	8	-0.005 -0.014
10	10	-0.006 -0.017
12	12	-0.006 -0.017
13	13	-0.007 -0.020
16	16	-0.007 -0.020

- ⚠ SUS440C Equivalent has an identification groove on D part.
- ⚠ When wall thickness of the pilot hole and P shaft head is low, strength may be low. (See table below for Pilot Hole depths).
- ⚠ When the OAL is shorter than the pilot hole, the pilot hole may go through. (See table below for Pilot Hole depths).
- ⚠ D dim. 8, M5 size may break if tightened with torque over 4.6N·M.

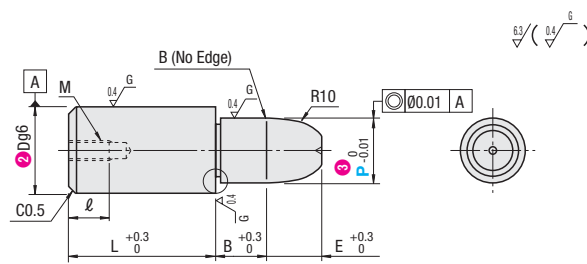

List of Internal Thread Pilot Holes

Tap Diameter	M2.6	M3	M4	M5	M8
Pilot Hole Dia. d ₂	2.3	2.6	3.4	4.3	6.9
Pilot Hole Depth U	8.5	9.5	12	14.5	21

⚠ Pilot hole depth is for reference.

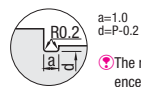
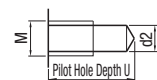

⚠ The relief dimensions are for reference and are not guaranteed values.

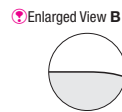

⚠ Enlarged View B

Part Number	③P Selection				L	B	E	D	M (Coarse)	ℓ
	①Type	②No.								
JPRSTB GJPRSTB CJPRSTB SJPRSTB	6	4	5	6	10	5	5	6	M3	5
	6T	4	5	6	10	5	5	6	M2.6	4
	8		6	8	15	6	5	8	M4	6
	8T		6	8	15	6	5	8	M3	5
	10		8	10	15	8	5	10	M5	8
	12		8	10	15	8	6	12	M5	8
	13		12	13	22	8	6	13	M8	12
	16		12	13	22	10	7	16	M8	12
	20		15	16	30	10	7	20	M8	12



Alterations

Alterations	Radius
Spec.	For detail of machining and Ordering Code, see the WEB Catalog.

Locating Pins Small Head Round Tapered

- D and P Tolerance / Taper R Selectable -

■ Features: Dimensions of Large Head Tapered Type are freely configurable. Tolerances of both ends and taper dimensions are also configurable.

When ordering, select Part Number and Values from Selection Steps ①~⑨.

Ordering Example: Part Number (①Type · ②D Tolerance · ③P Tolerance · ④No.) - ⑤P - ⑥L - ⑦B - ⑧E - ⑨R
KFPSTMS10T - P8.00 - L12 - B8 - E3.5 - R15



Type Internal Thread	Material	Surface Treatment	Hardness
KFPST	SKS3 Equivalent	-	Treated Hardness: 60 ~ 63HRC
GKFPST	SKS3 Equivalent	Hard Chrome Plating Plating Thickness: 3μm or More	Treated Hardness: 60 ~ 63HRC Plating Hardness: 750HV ~
CKFPST	SUS440C Equivalent	-	Treated Hardness: 50 ~ 55HRC
SKFPST	SUS304 Equivalent	-	-

Tolerance Selection

D or P	②D and P Tolerance				
	M	P	G	H	S
4.00~6.00	+0.012 +0.004	+0.020 +0.012	-0.004 -0.012	0 -0.012	-
6.01~10.00	+0.015 +0.006	+0.024 +0.015	-0.005 -0.014	0 -0.015	0 -0.01
10.01~18.00	+0.018 +0.007	+0.029 +0.018	-0.006 -0.017	0 -0.018	-
18.01~20.00	+0.021 +0.008	+0.035 +0.022	-0.007 -0.020	0 -0.021	-

- ⚠ SUS440C Equivalent has an identification groove on D part.
- ⚠ When wall thickness of the pilot hole and P shaft head is low, strength may be low. (See table below for Pilot Hole depths).
- ⚠ When the OAL is shorter than the pilot hole, the pilot hole may go through. (See table below for Pilot Hole depths).
- ⚠ D dim. 8, M5 size may break if tightened with torque over 4.6N·M.



⚠ The relief dimensions are for reference and are not guaranteed values.

List of Internal Thread Pilot Holes

Tap Diameter	M2.6	M3	M4	M5	M6	M8
Pilot Hole Dia. d ₂	2.3	2.6	3.4	4.3	5.1	6.9
Pilot Hole Depth U	8.5	9.5	12	14.5	17	21

⚠ Pilot hole depth is for reference.

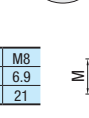

$$\sqrt[6]{\frac{E}{L}} \left(\frac{0.4}{L} \right)^6$$

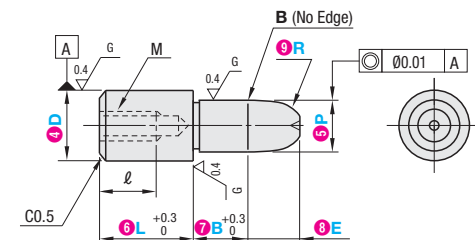

⚠ The relief dimensions are for reference and are not guaranteed values.

⚠ When D=P, there will be no relief.
 (i) When D=P and tolerances are different

(ii) When D=P and tolerances are the same

⚠ Enlarged View B

Part Number	①Type	②D Tolerance Selection	③P Tolerance Selection	④No.	⑤P Configurable Unit 0.01mm	⑥L Configurable Unit 1mm	⑦B 0.5mm Increment	⑧E Configurable Unit 0.5mm	⑨R Selection	D	M (Coarse)	ℓ
6T	4.00~6.00	8~12	3.0~12.0	6	M2.6	4						
8	6.00~8.00	11~16	3.0~14.0	8	M5	8						
8T	6.00~8.00	11~16	3.0~14.0	8	M4	6						
10	7.00~10.00	11~20	3.0~16.0	10	M5	8						
10T	7.00~10.00	8~16	3.0~16.0	10	M4	6						
12	7.00~12.00	12~24	3.0~18.0	12	M5	8						
12T	7.00~12.00	8~18	3.0~18.0	12	M4	6						
13	8.00~13.00	13~26	3.0~20.0	13	M8	10						
13T	8.00~13.00	10~20	3.0~20.0	13	M6	9						
16	10.00~16.00	16~32	3.0~20.0	16	M8	12						
16T	10.00~16.00	10~24	3.0~20.0	16	M6	9						
20	13.00~20.00	20~40	3.0~20.0	20	M8	12						
20T	13.00~20.00	12~30	3.0~20.0	20	M6	9						

⚠ Specifiable value depends on P dimension. Confirm "Details of E Dimension and R Dimension Range" in the table.

Details of E and R Dimension Range

P Configurable Unit 0.01mm	E Configurable Unit 0.5mm	R Selection
4.00	1.0~ 2.0	5 10
4.01~ 8.00	2.5~ 4.0	10 15
8.01~12.00	4.5~ 7.0	10 15 20
12.01~16.00	5.0~10.0	15 20 25
16.01~20.00	5.0~15.0	20 25 30



Alterations

Alterations	Insertion Guide Machining	Radius	Air Vent
Spec.	For detail of machining and Ordering Code, see the WEB Catalog.		