

# Bushings for Inspection Components

## Straight (Standard, Press Fit Type)

For compatible Pins, see P.1819-P.1820 and P.1840.

### Standard Type



RoHS 10

Material	Hardness	Surface Treatment	Type			
			P, L Selectable		P, L Configurable	
			P <sup>+0.03/-0.01</sup>	PH7	P <sup>+0.03/-0.01</sup>	PH7
SKS93 Equivalent (Raw Material)	-	-	-	-	KJBNS	KJBNSN
SKS93 Equivalent	50~60HRC	-	KJBA	KJBHA	KJBS	KJBHS
SKS93 Equivalent	50~60HRC	Electroless Nickel Plating	-	-	KJBMS	KJBHSM
SUS304 <sup>②</sup>	-	-	-	-	KJBSS	KJBHSS
SUS440C or 13Cr stainless	45~50HRC	-	-	-	KJBSSC	KJBHSSC

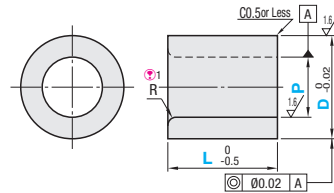

P	H7
2.00-3.00	+0.001 0
3.01-6.00	+0.012 0
6.01-10.00	+0.015 0
10.01-18.00	+0.018 0
18.01-30.00	+0.021 0
30.01-32.00	+0.025 0

①. When wall is 2mm or less ((D-P)/2≤2), R is 0.5.

### P, L Selectable

Part Number Type	D	P Selection	L Selection	R	Unit Price
(P <sup>+0.03</sup> ) KJBA	10	3	10	1.0	
		4	10 15	1.0	
		5	10 15	1.0	
		6	10 15	0.5	
		8	15	0.5	
		6	15	2.0	
	12	8	15 20	0.5	
		10	15	0.5	
		10	15 20	2.0	
		12	15 20	0.5	

Part Number Type	D	P Selection	L Selection	R	Unit Price
(PH7) KJBHA	10	4	10 15	1.0	
		5	15	1.0	
		6	15	0.5	
		6	15	2.0	
		8	15 20	0.5	
		8	15 20	2.0	
	12	10	15 20	2.0	
		10	15 20	2.0	
		13	20 25	0.5	

### P, L Configurable P Dimension Tolerance<sup>+0.03/-0.01</sup>

Part Number Type	D	P 0.01mm Increment	L 1mm Increment	R	Unit Price				
					KJBNS	KJBS	KJBMS	KJBSS	KJBSSC
(SKS93 Equivalent Raw Material) KJBNS	8	2.00~ 6.00	5~40 When P<5 L≤Px4 When P≥5 L≤Px3	1.0					
	10	2.00~ 8.00		1.0					
(SKS93 Equivalent Hardened) KJBS	12	4.00~10.00		2.0					
	16	8.00~14.00		2.0					
(SKS93 Equivalent Hardened, Electroless Nickel Plating) KJBMS	20	10.00~18.00		2.0					
	25	15.00~23.00		2.0					
(SUS304) KJBSS	30	20.00~27.00		2.0					
	35	25.00~32.00		2.0					

### P, L Configurable P Dimension Tolerance H7

Part Number Type	D	P 0.01mm Increment	L 1mm Increment	R	Unit Price				
					KJBNSN	KJBHS	KJBHSM	KJBHSS	KJBHSSC
(SKS93 Equivalent Raw Material) KJBNSN	8	2.00~ 6.00	5~40 When P<5 L≤Px4 When P≥5 L≤Px3	1.0					
	10	2.00~ 8.00		1.0					
(SKS93 Equivalent Hardened) KJBHS	12	4.00~10.00		2.0					
	16	8.00~14.00		2.0					
(SKS93 Equivalent Hardened, Electroless Nickel Plating) KJBHSM	20	10.00~18.00		2.0					
	25	15.00~23.00		2.0					
(SUS304) KJBHSS	30	20.00~27.00		2.0					
	35	25.00~32.00		2.0					

②. For SUS304, there must be a 2mm or greater wall thickness ((D-P)/2≥2). ③. D=30 and 35 are applicable to SKS93 (except electroless nickel plating) only.

For compatible Pins, see P.1819-P.1820 and P.1840.

### Press Fit Type



Material	Hardness	Surface Treatment	Type	
			P <sup>+0.03/-0.01</sup>	PH7
SKS93 Equivalent	50~60HRC	-	KJBPS	KJBPHS
SKS93 Equivalent	50~60HRC	Electroless Nickel Plating	KJBPSM	KJBPHSM
SUS304 <sup>②</sup>	-	-	-	KJBPHSS
SUS440C or 13Cr stainless	45~50HRC	-	KJBPSSC	KJBPHSSC

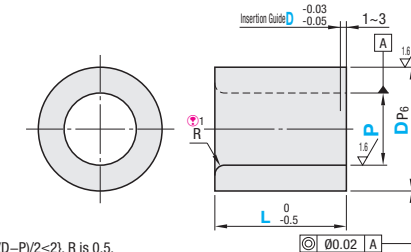

P	H7
2.00-3.00	+0.001 0
3.01-6.00	+0.012 0
6.01-10.00	+0.015 0
10.01-18.00	+0.018 0
18.01-30.00	+0.021 0
30.01-32.00	+0.025 0

①. When wall is 2mm or less ((D-P)/2≤2), R is 0.5.

### P, L Configurable P Dimension Tolerance<sup>+0.03/-0.01</sup>

Part Number Type	D	P 0.01mm Increment	L 1mm Increment	R	Unit Price		
					KJBPS	KJBPSM	KJBPSSC
(SKS93 Equivalent Hardened) KJBPS	8	2.00~ 6.00	5~40 When P<5 L≤Px4 When P≥5 L≤Px3	1.0			
	10	2.00~ 8.00		1.0			
	12	4.00~10.00		2.0			
(SKS93 Equivalent Hardened, Electroless Nickel Plating) KJBPSM	16	8.00~14.00		2.0			
	20	10.00~18.00		2.0			
	25	15.00~23.00		2.0			
(SUS440C or 13Cr stainless) KJBPSSC	30	20.00~27.00		2.0			
	35	25.00~32.00		2.0			

### P, L Configurable P Dimension Tolerance H7

Part Number Type	D	P 0.01mm Increment	L 1mm Increment	R	Unit Price			
					KJBPHS	KJBPHSM	KJBPHSS	KJBPHSSC
(SKS93 Equivalent Hardened) KJBPHS	8	2.00~ 6.00	5~40 When P<5 L≤Px4 When P≥5 L≤Px3	1.0				
	10	2.00~ 8.00		1.0				
(SKS93 Equivalent Hardened, Electroless Nickel Plating) KJBPHSM	12	4.00~10.00		2.0				
	16	8.00~14.00		2.0				
	20	10.00~18.00		2.0				
(SUS304) KJBPHSS	25	15.00~23.00		2.0				
	30	20.00~27.00		2.0				
(SUS440C or 13Cr stainless) KJBPHSSC	35	25.00~32.00		2.0				

②. For SUS304, there must be a 2mm or greater wall thickness ((D-P)/2≥2).

Ordering Example	Part Number	D	P	L
	KJBA	10	P5	L15
	KJBNS	12	P6.53	L20

Alterations	Part Number	P	L	(FC, NC-etc.)
	KJBNS10	P3.00	L6	STC
	KJBNS12	P6.00	L20	CRN

④. Applicable to P, L Dimension Configurable Type only.

Alterations	Code	Spec.
Groove (for Adhesive Reservoir)	FC	Adds an adhesive reservoir groove. ④D≥P+3: Applicable only when a wall of 1.5mm or thicker is remaining. ④Applicable only when L≥10.
Groove (for Retaining)	NC	Adds groove for retaining. ④D≥P+3: Applicable only when a wall of 1.5mm or thicker is remaining. ④Applicable only when L≥10.
Radius R C Chamfered	RN	Adds C Chamfering (0.5 or less) to R.

Alterations	Code	Spec.
Radius R Square Corner	CRN	Replaces R with square corner. ④Edge may be burred. ④Combination with alteration LKC is not available.
Additional Surface Treatment (Black Oxide)	STC	Adds black oxide surface treatment. ④Applicable only to material SKS93 (except electroless nickel plating).
L Dimension Tolerance	LKC	Changes L dimension tolerance to <sup>0</sup> -0.05. ④Combination with alteration CRN is not available.
Flats Machining	HT	Adds a flat on bushing.