

# Miniature Linear Guides - Heat Resistant

Short / Standard / Long Blocks, Light Preload

**Features:** Usable at up to 150°C of operating temperature since heat resistant parts and grease are employed.

Industry Standard



Material Hardness	Type			L Dimension	Number of Blocks
	Light Preload				
	Short	Standard	Long		
Stainless Steel 56HRC~	SSEBST	SSEBT	SSELBT	Selectable	1
	SSE2BST	SSE2BT	SSEL2BT		2
	SSEBSLT	SSEBLT	SSELBLT	Configurable	1
	SSE2BSLT	SSE2BLT	SSEL2BLT		2

Heat Resistant Temperature: -20 ~ 150°C

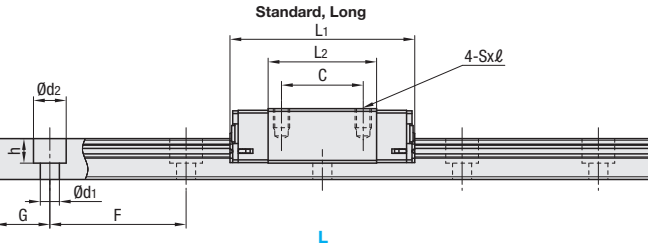
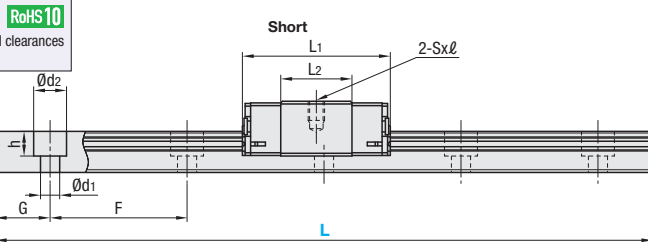

For L Configurable, G dimensions differ from those shown in the table below. For details, see P. 531.

RoHS 10  
Blocks and rails are not sold as separate items. This type has guaranteed radial clearances and accuracies as sets of blocks and rails.

- Precautions for Use**
  - Blocks are equipped with retainers (wire) to prevent balls from falling off. For how to handle the blocks, see P. 525.
  - Radial clearances and accuracies are not guaranteed if the blocks and rails are interchanged from the original set combinations.
  - Straight grooves are provided on datum planes. Be sure to match the datum lines when using.
  - Rails cannot be connected end to end.
  - The accuracy of Linear Guides is guaranteed after mounting the rail (after fastening screws on the rail and pushing it onto the datum plane). Minor bending of the rail will be adjusted after being mounted and will not affect the performance.
- Accessory**
  - H8 comes with cap screws (M2x6).
- Others**
  - Filled with heat resistant grease (Du Pont KRYTOX GPL225).
  - Stainless steel and fluoro-rubber are used for return caps and seals respectively.
  - For operating life calculation, see P. 527.
  - For operating life calculations, use our free calculation software from [http://download.misumi.jp/mol/fa\\_soft.html](http://download.misumi.jp/mol/fa_soft.html).

Part Number	Type	H	L	Block Type	Block Dimension				Guide Rail Dimension										
					W	L1	B	C	Sxℓ	L2	K	Cb	H1	W1	W2	Ca	Counterbored Hole d1xd2xh	F	G
Short (1 block) SSEBST SSEBSLT	(2 blocks) SSE2BST SSE2BSLT	8	40~130 (70)	Short	17	19.6	-	-	M2x2.5	9.6	6.5	0.3	4.7	7	5	0.3	2.4x4.2x2.3	15	5
				Standard	17	23.6	12	8	13.6	6.5	0.3	4.7	7	5	0.3	2.4x4.2x2.3	15	5	
				Long	17	32	12	13	22	6.5	0.3	4.7	7	5	0.3	2.4x4.2x2.3	15	5	
Standard (1 block) SSEBT SSEBLT	(2 blocks) SSE2BT SSE2BLT	10	35~275 (95)	Short	20	22.9	-	-	M3x3	11.9	7.8	0.3	5.5	9	5.5	0.3	3.5x6x3.5	20	7.5
				Standard	20	30	15	10	19	7.8	0.3	5.5	9	5.5	0.3	3.5x6x3.5	20	7.5	
				Long	20	40	15	16	29	7.8	0.3	5.5	9	5.5	0.3	3.5x6x3.5	20	7.5	
Standard (1 block) SSEBT SSEBLT	(2 blocks) SSE2BT SSE2BLT	13	45~470 (120)	Short	27	27	-	-	M3x3.5	13	10	0.5	7.5	12	7.5	0.5	3.5x6x4.5	25	10
				Standard	27	33.9	20	15	19.9	10	0.5	7.5	12	7.5	0.5	3.5x6x4.5	25	10	
				Long	27	45.8	20	20	31.8	10	0.5	7.5	12	7.5	0.5	3.5x6x4.5	25	10	
Long (1 block) SSELBT SSELBLT	(2 blocks) SSEL2BT SSEL2BLT	16	70~670 (150)	Short	32	32.7	-	-	M3x4	17.7	12	0.5	9.5	15	8.5	0.5	3.5x6x4.5	40	15
				Standard	32	42.4	25	20	27.4	12	0.5	9.5	15	8.5	0.5	3.5x6x4.5	40	15	
				Long	32	58.3	25	25	43.3	12	0.5	9.5	15	8.5	0.5	3.5x6x4.5	40	15	

H	Block Type	Basic Load Rating		Allowable Static Moment			Mass	
		C (Dynamic) kN	Co (Static) kN	MA N-m	MB N-m	MC N-m	Block kg	Guide Rail kg/m
8	Short	0.79	1.27	1.9	1.6	4.6	0.008	0.19
	Standard	0.9	1.5	4.1	4.1	5.2	0.01	
	Long	1.6	2.4	7.5	7.5	9	0.02	
10	Short	1.16	1.68	3.1	2.6	7.9	0.015	0.31
	Standard	1.5	2.5	5.1	5.1	10.2	0.02	
	Long	2.2	3.7	12.3	12.3	13	0.03	
13	Short	1.63	2.38	5.2	4.4	14.8	0.025	0.61
	Standard	2.2	3.3	8.8	9.5	16.1	0.04	
	Long	3.5	5.3	24.5	26.4	32.3	0.06	
16	Short	3.08	4.23	12.3	10.3	32.6	0.05	1.02
	Standard	3.6	5.4	21.6	23.4	39.6	0.06	
	Long	5.8	8.7	57.8	62.6	67.6	0.1	

Preload and Accuracy Standards

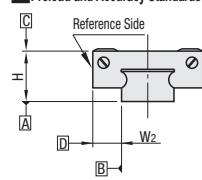

Specifications	Unit: μm
Radial Clearance	-3~0
Height H Tolerance	±20
Pair Variation of Height H	15
Width W2 Tolerance	±25
Pair Variation of Width W2	20
Running Parallelism of Plane C against Plane A	See P. 525
Running Parallelism of Plane D against Plane A	See P. 525

H	L	Unit Price				
		Short	Standard	Long	SSEBST	SSE2BST
8	40	-	-	-	-	-
	55	-	-	-	-	-
	70	-	-	-	-	-
	85	-	-	-	-	-
	100	-	-	-	-	-
	115	-	-	-	-	-
	130	-	-	-	-	-
	35	-	-	-	-	-
	55	-	-	-	-	-
	75	-	-	-	-	-
10	95	-	-	-	-	-
	115	-	-	-	-	-
	135	-	-	-	-	-
	155	-	-	-	-	-
	175	-	-	-	-	-
	195	-	-	-	-	-
	215	-	-	-	-	-
	235	-	-	-	-	-
	255	-	-	-	-	-
	275	-	-	-	-	-
13	45	-	-	-	-	-
	70	-	-	-	-	-
	95	-	-	-	-	-
	120	-	-	-	-	-
	145	-	-	-	-	-
	170	-	-	-	-	-
	195	-	-	-	-	-
	220	-	-	-	-	-
	245	-	-	-	-	-
	270	-	-	-	-	-
16	295	-	-	-	-	-
	320	-	-	-	-	-
	345	-	-	-	-	-
	370	-	-	-	-	-
	395	-	-	-	-	-
	420	-	-	-	-	-
	445	-	-	-	-	-
	470	-	-	-	-	-
	70	-	-	-	-	-
	110	-	-	-	-	-
150	-	-	-	-	-	
190	-	-	-	-	-	
230	-	-	-	-	-	
270	-	-	-	-	-	
310	-	-	-	-	-	
350	-	-	-	-	-	
390	-	-	-	-	-	
430	-	-	-	-	-	
470	-	-	-	-	-	
510	-	-	-	-	-	
550	-	-	-	-	-	
590	-	-	-	-	-	
630	-	-	-	-	-	
670	-	-	-	-	-	

L Dimension Configurable Type (1mm Increment)

H	Unit Price				
	Short	Standard	Long	SSEBSLT	SSE2BSLT
8	-	-	-	-	-
10	-	-	-	-	-
13	-	-	-	-	-
16	-	-	-	-	-

For calculation of L Dimension Configurable Type (1mm Increment), add the above amount to the unit price of the Selectable Type longer than, and closest to this L Dimension Configurable Type.

Ordering Example  
Part Number - L  
SSEBT10 - 195

Alterations  
Part Number - L - (MC, RLC, LLC, B3, B4)  
SSEBLT16 - 450 - MC

Alterations	Code	Spec.
Tapped Hole	MC	Changes the rail mounting holes from counterbored holes to tapped holes. H MC 8 M3 10 M4 13 M4 16 M5
Rail End Cut	LLC, RLC	Cuts rail ends. Ordering Code LLC H L Cut N 10 2.5 5 13 5 5 16 10 5 Rail is cut with the product ID facing out (datum on other side). Right End Cut RLC Applicable to Selectable Type only. Overall length will be shorter by cutting. Not applicable to H8. Not applicable to L35 of H10 and L45 of H13.
3-Block Specifications	B3	Add 2 blocks to 1-block product to ship as 3-block separate item. There are restrictions for the L dimension length. See "Selectable Shortest Rail Length" for details. Selection Example: SSEBST10-95-B3
4-Block Specifications	B4	Add 3 blocks to 1-block product to ship as 4-block separate item. There are restrictions for the L dimension length. See "Selectable Shortest Rail Length" for details. Selection Example: SSEBLT16-550-B4

Additional Block Price				Selectable Shortest Rail Length for B3/B4			
H	Block	B3: Price Adder	B4: Price Adder	H	Block	B3 (3-block)	B4 (4-block)
8	Short	-	-	8	Short	85	100
	Standard	-	-		Standard	85	115
	Long	-	-		Long	-	-
10	Short	-	-	10	Short	95	115
	Standard	-	-		Standard	115	155
	Long	-	-		Long	155	195
13	Short	-	-	13	Short	120	145
	Standard	-	-		Standard	145	170
	Long	-	-		Long	170	220
16	Short	-	-	16	Short	150	190
	Standard	-	-		Standard	190	230
	Long	-	-		Long	230	270

Options for Linear Guide

Position Retaining Parts	Block / Rail Fixing Parts