

# Clamp Levers

Baked Paint

Type		L	Lever		Screw		Spring
Threaded	Tapped	Dimension	Material	Surface Treatment	Material	Surface Treatment	Material
CLDM	CLDF	L Dimension Selectable	Zinc Die Casting	Baked Paint	SUM23	Black Chromate	SUS304-WPB
CLMD	CLDFM				S45C	Electroless Nickel Plating	
CLMS	CLFS				SUS303	-	
CLMSF	-	L Dimension Configurable	-	-	-	-	-

**Threaded**  
**CLDM**  
(Thread: Black Chromate)  
**CLMD**  
(Thread: Electroless Nickel Plating)  
**CLMS**  
(Thread: Stainless Steel)  
**CLMSF**  
(Thread: Stainless Steel)

**Tapped**  
**CLDF**  
(Thread: Black Chromate)  
**CLDFM**  
(Thread: Electroless Nickel Plating)  
**CLFS**  
(Thread: Stainless Steel)

⚠ Hex Socket B is created during a production of Levers. It is not a socket used during an installation of Levers.

M	R	H	H <sub>1</sub>	(h)	S	D	d	Number of Serrated Teeth	B	Max. Load F <sub>max.</sub> (N)			Max. Tightening Force P <sub>max.</sub> (kN)			Reference Mass (g)	
										SUM24L	SUS303	S45C	SUM24L	SUS303	S45C	Threaded	Tapped
4	45	35	38.5	25.8	4	13	10	16	3	55	48	80	2.0	1.8	3.0	33	31
5										74	65	108	3.3	2.9	4.8	34	31
6										126	110	184	4.7	4.1	6.8	40	30
8	63.5	45	48.5	32.3	7	17.5	14	20	4	217	189	316	8.6	7.5	12.5	70	73
10	78.5	54	58	37.6	8	21	16	24	4	347	303	507	13.6	11.8	19.8	152	113
12	93	67.5	71.5	45.6	14	24	19	28	4	511	446	746	19.8	17.2	28.9	220	174

Part Number	Type	M	L Selection	Lever Color	Unit Price		
					CLDM	CLMD	CLMS
Threaded CLDM CLMD CLMS	4	(8) 12 16 20 25 *(32)	B (Black)				
	5	(8) 12 16 20 25 32 *(40)	M (Orange)				
	6	(8) 12 16 20 25 32 (40) *(50)	S (Silver Gray)				
	8	16 20 25 32 40 (50)	R (Red)				
	10	20 25 32 40 50 (63)	Y (Yellow)				
	12	25 32 40 50 (63)					

Part Number	Type	M	L Selection	Lever Color	Unit Price
L Dimension Configurable CLMSF	4	12~25	B (Black)		
	5	12~32	M (Orange)		
	6	12~32	S (Silver Gray)		
	8	16~40	R (Red)		
	10	20~50	Y (Yellow)		
	12	25~50			

\* marked units have incomplete thread section 10mm or less, others 3.5mm or less.  
 ⚠ Dimensions in ( ) are applicable to CLDM only. ⚠\* marked items are applicable to S (silver gray) only.

Part Number	Type	M	L	Lever Color	Unit Price		
					CLDF	CLDFM	CLFS
Tapped CLDF CLDFM CLFS	4	7	B (Black)				
	5	7	M (Orange)				
	6	7	S (Silver Gray)				
	8	10	R (Red)				
	10	14	Y (Yellow)				
	12	17					

Ordering Example  
 Part Number - L - Lever Color  
 CLDM8 - 40 - B  
 CLDF8 - 10 - S

### How to Use

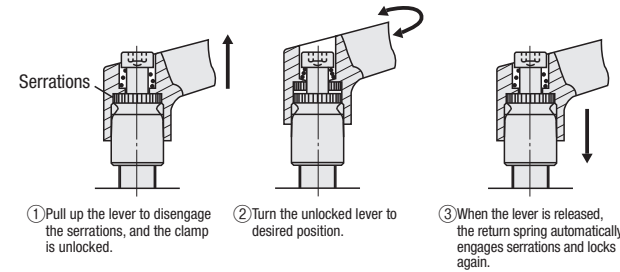

### Load Direction of Clamp Lever

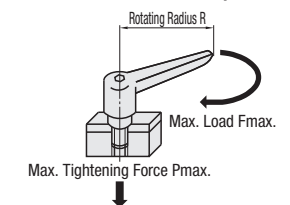

# Clamp Levers

Stainless Steel

Type		L	Lever		Screw		Spring
Threaded	Tapped	Dimension	Material	Surface Treatment	Material	Surface Treatment	Material
SCLDM	SCLDF	L Dimension Selectable	Zinc Die Casting	Buff Polished	SUS13	Stainless Cast Steel	SUS304-WPB
CLCM	CLCF				SUS303	Chrome Plating, Chrome over Satin Nickel	
CLCMD	-				-	Copper Plating + Nickel Plating	

**Threaded**  
**SCLDM**  
(Stainless Steel)  
**CLCM**  
(Thread: Stainless Steel)  
**CLCMD**  
(Thread: Stainless Steel)

**Tapped**  
**SCLDF**  
(Stainless Steel)  
**CLCF**  
(Thread: Stainless Steel)

⚠ Hex Socket B is created during a production of Levers. It is not a socket used during an installation of Levers.

M	R	H	H <sub>1</sub>	(h)	S	D	d	Number of Serrated Teeth	B	Max. Load F <sub>max.</sub> (N)		Max. Tightening Force P <sub>max.</sub> (kN)		Reference Mass (g)	
										SUM24L	SUS303	SUM24L	SUS303	Threaded	Tapped
4	45	35	38.5	25.8	4	13	10	16	3	48	1.8	33	31		
5										65	2.9	34	31		
6										110	4.1	40	30		
8	63.5	45	48.5	32.3	7	17.5	14	20	4	189	7.5	70	73		
10	78.5	54	58	37.6	8	21	16	24	4	303	11.8	152	113		
12	93	67.5	71.5	45.6	14	24	19	28	4	446	17.2	220	174		

### Buff Finished (Stainless Steel)

Part Number	Type	M	L Selection				Unit Price
			4	5	6	6	
Threaded SCLDM	4	12 16 20 25					
	5	12 16 20 25 32					
	6	12 16 20 25 32					

Part Number	Type	M	L	Lever Color	Unit Price
Tapped SCLDF	4				
	5				
	6				

### Chrome Plating, Chrome over Satin Nickel

Part Number	Type	M	L Selection				Lever Color	Unit Price
			4	5	6	6		
Threaded CLCM	4	12 16 25				C (Chrome Plating)		
	5	12 16 20 25 32						
	6	12 16 20 25 32						
	8	16 20 25 32 40				SC (Satin Nickel Chrome Plating)		
	10	20 25 32 40 50						
	12	25 32 40 50						

Part Number	Type	M	L	Lever Color	Unit Price
Tapped CLCF	5	7		C (Chrome Plating)	
	6	7			
	8	10		SC (Satin Nickel Chrome Plating)	
	10	14			

### Copper Plating + Nickel Plating

Part Number	Type	M	L Selection				Lever Color	Unit Price
			4	5	6	6		
Threaded CLCMD	4	12 16 20 25				NC (Copper Plating)		
	5	12 16 20 25 32						
	6	12 16 20 25 32						

Ordering Example  
 Part Number - L - Lever Color  
 CLCM8 - 20 - SC  
 CLCMD6 - 25 - NC

⚠ Since CLCMD is nickel-plated over the copper base, the lever part is antistatic.