

# Angled Brackets

For 8 Series (Slot Width 10mm) Aluminum Extrusions

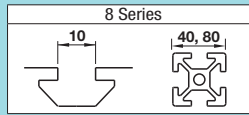

Features: Extruded Brackets to connect extrusions at angles.

## Angled Brackets

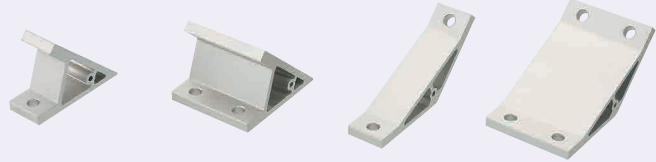

Type	Material	Surface Treatment
HBL45T8	A6N01SS-T5	Anodize
HBL135T8	A6N01SS-T5	Anodize

HBL45TS8

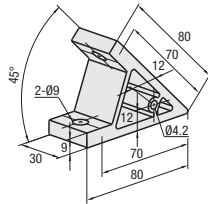

HBL45TD8

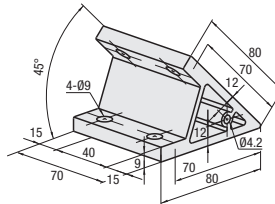

HBL135TS8

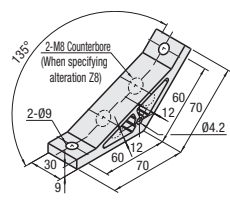

HBL135TD8

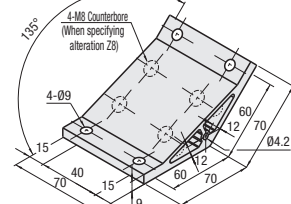

Part Number	Mass (g)	Applicable Screw, T Nut		Allowable Load (N)	Unit Price (1-99 pc(s))	Volume Discount Rate (100-200)
		Screw	T Nut			
HBL45TS8	88	CBM8-20	HNTT8-8	2058		
HBL45TD8	204	CBM8-20	HNTT8-8	2940		
HBL135TS8	103	CBM8-20	HNTT8-8	2058		
HBL135TD8	240	CBM8-20	HNTT8-8	2940		

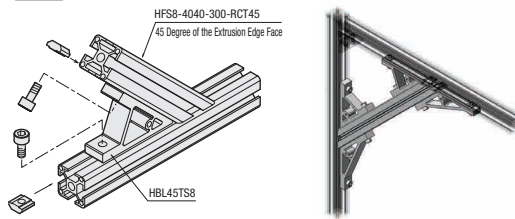

Ordering Example Part Number HBL45TS8 (C, SET, SST, SEU, SSU, SEP, SSP, Z8)

Alterations Part Number HBL45TS8 (C, SET, SST, SEU, SSU, SEP, SSP, Z8) SET

Alterations	Code	Spec.	Applicable Bracket
Mounting Hole Alteration for Cover	C	Adds taps on a bracket for cover mounting. (M5 on Both Sides, Depth 15mm) (Mounting Screw HC8M on P754)	HBL45TS8 HBL135TS8
Counterbored Holes on 135 Degree Bracket	Z8	135 Degree Bracket Adds two counterbored holes on HBL135T8. (Applicable Screws: M8)	HBL135TS8 HBL135TD8

Alterations	Code	Spec.	Applicable Bracket
Applicable Screws and Nuts Set	SET	Applicable screws and nuts for fixing the brackets on extrusions come in a set. (Adds to the bracket price.)	HBL45TS8
	SST	(Stainless Steel)	HBL45TS8
	SEU	Pre-Assembly Insertion Spring Nuts	HBL45TS8
	SSU	Pre-Assembly Insertion Spring Nuts Stainless Steel	HBL45TS8
	SEP	Post-Assembly Insertion Spring Nuts	HBL135TS8
	SSP	Post-Assembly Insertion Spring Nuts Stainless Steel	HBL135TD8

Included Screw is not RoHS compliant when -SET, -SEU or -SEP are specified.

# Free Angle Brackets

For 8 Series (Slot Width 10mm) Aluminum Extrusions

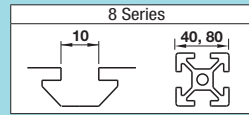

Features: Extrusions can be connected at any arbitrary angles.

## Free Angle Brackets



Type	Material	Surface Treatment
HBLTBA40	A6N01SS-T5	Anodize
HBLTBBN40	A6N01SS-T5	Anodize
HBLTBC40	A6N01SS-T5	Anodize
HBLTBD40	A6N01SS-T5	Anodize

Part Number	Applicable Extrusion	Mass (g)	Accessory	Unit Price (1-14 pc(s))	Volume Discount Rate (15-50)
HBLTBA40	40 Square (HFS8)	97	M10x16	1	
HBLTBBN40	40 Square (HFS8)	98	M10x16	1	
HBLTBC40	40 Square (HFS8)	267	CLDM8-40-M	1	
HBLTBD40	40 Square (HFS8)	269	CLDM8-40-M	1	

Ordering Example Part Number HBLTBA40

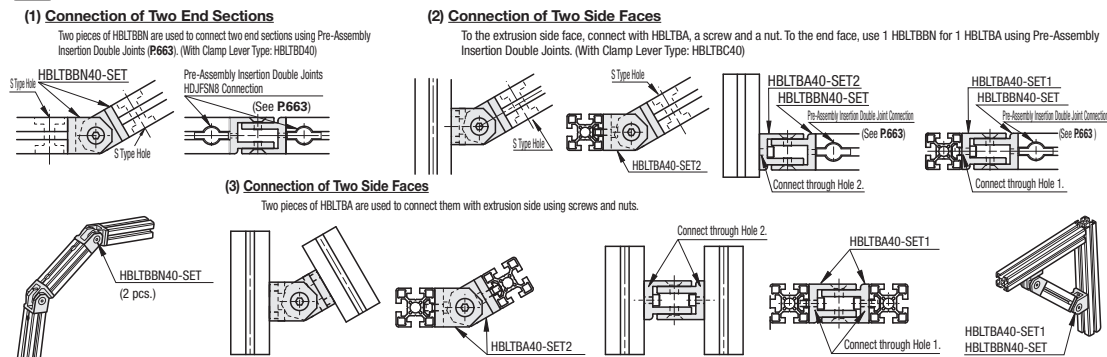

Features: Sheet Metal Brackets to fix at arbitrary positions.

## Free Angle Sheet Metal Brackets



Material: SPCC Surface Treatment: Trivalent Chromate

Part Number	Applicable Extrusion	Applicable Screw and Nut	Unit Price (1-99 pc(s))	Volume Discount Rate (100-150)
HBLPBL	40 Square (HFS8)	CBST8-15	4	
HBLPBR	40 Square (HFS8)	HNTT8-8	4	



## Extrusion Side Face Connection Type

HBLTBA40 (An order of quantity 1 includes 1 pc.)

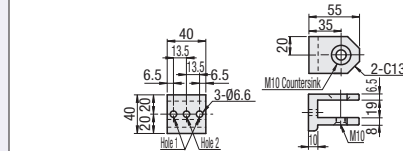

## Clamp Lever Type

HBLTBC40 (An order of quantity 1 includes 1 pc. each of ① and ③.)  
HBLTBD40 (An order of quantity 1 includes 1 pc. each of ② and ③.)

## ① Extrusion Side Face Connection Type

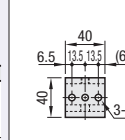

## ② Extrusion Cross Section Connection Type

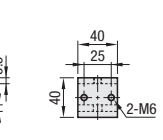

## Extrusion Cross Section Connection Type

HBLTBBN40 (An order of quantity 1 includes 1 pc.)

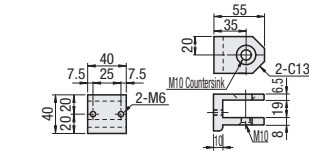

## ③ Extrusion Cross Section Connection Type (Base)

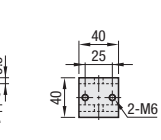

Alterations	Code	How to Use	Part Number	Quantity	Accessory	Quantity
Applicable Screws and Nuts Set	SET1	Use the hole 1	HBLTBBN	2	CBM6-35	2
	SET2	Use the hole 2	HBLTBA	2	HNTT8-6	2
	SET3	Use the hole 1	HBLTBC	2	CBM6-35	2
	SET4	Use the hole 2	HBLTBC	2	HNTT8-6	2
	SET5	Use the hole 2	HBLTBD	2	CBM6-35	2

When connecting with Pre-Assembly Insertion Double Joints, S type hole machining (P765) is required on extrusions.  
Included Screw is not RoHS compliant when -SET is specified.

Alterations	Code	Spec.	Applicable Bracket
Applicable Screws and Nuts Set	SET	Supplies a set of applicable screws and nuts for fixing the bracket to an extrusion.	HBLPBL8 HBLPBR8
Set with applicable screws, nuts and clamp levers	SET1	Applicable Screw: 3 pcs. Clamp Lever (LNP): 1 pc. Flat Washer (PWF): 1 pc. Applicable Nut: 4 pcs. Set with the above items.	HBLPBL8 HBLPBR8