

Counterbores in Specified Position

D Type Hole Alterations

Blind Joints which require this alteration

Single Joints
P609, etc.

Counterbores useable for various purposes are added at customer specified locations.

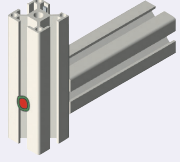

Top to Bottom (Vertical)
XA XB XC XD XE

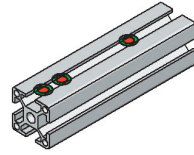

Right to Left (Horizontal)
YA YB YC YD YE

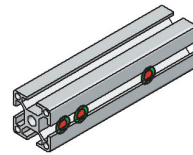

Cross Section View

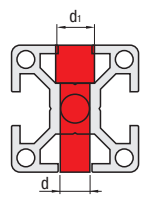

Counterbore is added on every slot for multiple slotted extrusions.

Alteration Code Specification Method

As for the Counterbore, it is possible to select one type of hole diameter in Z selection and specify up to five holes in one direction.
Specify the desired hole position from the left end.

Alterations	Counterboring				
	Code	Z Selection	d	d1	Distance from the Left End (0.5mm Increment)
Spec.	Extrusion Series	Z	d	d1	
Specify Counterbores and Locations	HFS5	5	5.5	9.5	
	HFS6	6	6.5	11	
	GF56	8	6.5	11	7-(L-7)
	HFS8-(45)	6	6.5	11	
	GF58	8	9	14	
		12	13	19	10-(L-10)



Ordering Example

Part Number
HFS6-3030-500-Z6-XA200-XB256

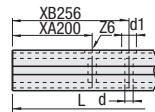

See the table below for the applicable extrusions and alteration charges. Indicated with "-" in the table are not applicable.

Alterations	Counterbores in Specified Position				
	Code	No.	Page	Counterbored	From Top to Bottom / From Right to Left
Four-Side Slots	HFS5	2020	P529		
	NFS5	2040	P530		
	GF55	2060	P531		
	GF56	2080	P532		
	GF57	2100	P533		
	GF58	2120	P534		
	GF59	2140	P535		
	GF60	2160	P536		
	GF61	2180	P537		
	GF62	2200	P538		
3-Side Slot 1 Side Flat	HFS5	2020	P529	Z5	d5.5
	NFS5	2040	P530		
	GF55	2060	P531		
	GF56	2080	P532		
	GF57	2100	P533		
	GF58	2120	P534		
	GF59	2140	P535		
	GF60	2160	P536		
	GF61	2180	P537		
	GF62	2200	P538		
Two-Side Slots Two Flats	HFS5	2020	P529		
	NFS5	2040	P530		
	GF55	2060	P531		
	GF56	2080	P532		
	GF57	2100	P533		
	GF58	2120	P534		
	GF59	2140	P535		
	GF60	2160	P536		
	GF61	2180	P537		
	GF62	2200	P538		
Two Slots on Opposite Sides	HFS5	2020	P529		
	NFS5	2040	P530		
	GF55	2060	P531		
	GF56	2080	P532		
	GF57	2100	P533		
	GF58	2120	P534		
	GF59	2140	P535		
	GF60	2160	P536		
	GF61	2180	P537		
	GF62	2200	P538		
One-Side Slot Three Flats	HFS5	2020	P529	Z6	d6.5
	NFS5	2040	P530		
	GF55	2060	P531		
	GF56	2080	P532		
	GF57	2100	P533		
	GF58	2120	P534		
	GF59	2140	P535		
	GF60	2160	P536		
	GF61	2180	P537		
	GF62	2200	P538		
Angled	HFS5	2020	P529		
	NFS5	2040	P530		
	GF55	2060	P531		
	GF56	2080	P532		
	GF57	2100	P533		
	GF58	2120	P534		
	GF59	2140	P535		
	GF60	2160	P536		
	GF61	2180	P537		
	GF62	2200	P538		
Black Anodize	HFS5	2020	P529		
	NFS5	2040	P530		
	GF55	2060	P531		
	GF56	2080	P532		
	GF57	2100	P533		
	GF58	2120	P534		
	GF59	2140	P535		
	GF60	2160	P536		
	GF61	2180	P537		
	GF62	2200	P538		
Curved	HFS5	2020	P529		
	NFS5	2040	P530		
	GF55	2060	P531		
	GF56	2080	P532		
	GF57	2100	P533		
	GF58	2120	P534		
	GF59	2140	P535		
	GF60	2160	P536		
	GF61	2180	P537		
	GF62	2200	P538		
Four-Side Slots	HFS6	3030	P571		
	NFS6	3050	P572		
	GF56	3070	P573		
	GF57	3090	P574		
	GF58	3110	P575		
	GF59	3130	P576		
	GF60	3150	P577		
	GF61	3170	P578		
	GF62	3190	P579		
	GF63	3210	P580		
3-Side Slot 1 Side Flat	HFS6	3030	P571		
	NFS6	3050	P572		
	GF56	3070	P573		
	GF57	3090	P574		
	GF58	3110	P575		
	GF59	3130	P576		
	GF60	3150	P577		
	GF61	3170	P578		
	GF62	3190	P579		
	GF63	3210	P580		
Two-Side Slots Two Flats	HFS6	3030	P571		
	NFS6	3050	P572		
	GF56	3070	P573		
	GF57	3090	P574		
	GF58	3110	P575		
	GF59	3130	P576		
	GF60	3150	P577		
	GF61	3170	P578		
	GF62	3190	P579		
	GF63	3210	P580		
Two Slots on Opposite Sides	HFS6	3030	P571		
	NFS6	3050	P572		
	GF56	3070	P573		
	GF57	3090	P574		
	GF58	3110	P575		
	GF59	3130	P576		
	GF60	3150	P577		
	GF61	3170	P578		
	GF62	3190	P579		
	GF63	3210	P580		
One-Side Slot Three Flats	HFS6	3030	P571	Z6	d6.5
	NFS6	3050	P572		
	GF56	3070	P573		
	GF57	3090	P574		
	GF58	3110	P575		
	GF59	3130	P576		
	GF60	3150	P577		
	GF61	3170	P578		
	GF62	3190	P579		
	GF63	3210	P580		
Light Type	HFS6	3030	P571		
	NFS6	3050	P572		
	GF56	3070	P573		
	GF57	3090	P574		
	GF58	3110	P575		
	GF59	3130	P576		
	GF60	3150	P577		
	GF61	3170	P578		
	GF62	3190	P579		
	GF63	3210	P580		
Heavy Type	HFS6	3030	P571		
	NFS6	3050	P572		
	GF56	3070	P573		
	GF57	3090	P574		
	GF58	3110	P575		
	GF59	3130	P576		
	GF60	3150	P577		
	GF61	3170	P578		
	GF62	3190	P579		
	GF63	3210	P580		
Angled	HFS6	3030	P571		
	NFS6	3050	P572		
	GF56	3070	P573		
	GF57	3090	P574		
	GF58	3110	P575		
	GF59	3130	P576		
	GF60	3150	P577		
	GF61	3170	P578		
	GF62	3190	P579		
	GF63	3210	P580		
Black Anodize	HFS6	3030	P571		
	NFS6	3050	P572		
	GF56	3070	P573		
	GF57	3090	P574		
	GF58	3110	P575		
	GF59	3130	P576		
	GF60	3150	P577		
	GF61	3170	P578		
	GF62	3190	P579		
	GF63	3210	P580		
Curved	HFS6	3030	P571		
	NFS6	3050	P572		
	GF56	3070	P573		
	GF57	3090	P574		
	GF58	3110	P575		
	GF59	3130	P576		
	GF60	3150	P577		
	GF61	3170	P578		
	GF62	3190	P579		
	GF63	3210	P580		
Four-Side Slots	HFS6	3030	P571		
	NFS6	3050	P572		
	GF56	3070	P573		
	GF57	3090	P574		
	GF58	3110	P575		
	GF59	3130	P576		
	GF60	3150	P577		
	GF61	3170	P578		
	GF62	3190	P579		
	GF63	3210	P580		
3-Side Slot 1 Side Flat	HFS6	3030	P571		
	NFS6	3050	P572		
	GF56	3070	P573		
	GF57	3090	P574		
	GF58	3110	P575		
	GF59	3130	P576		
	GF60	3150	P577		
	GF61	3170	P578		
	GF62	3190	P579		
	GF63	3210	P580		
Two-Side Slots Two Flats	HFS6	3030	P571		
	NFS6	3050	P572		
	GF56	3070	P573		
	GF57	3090	P574		
	GF58	3110	P575		
	GF59	3130	P576		
	GF60	3150	P577		
	GF61	3170	P578		
	GF62	3190	P579		
	GF63	3210	P580		
Two Slots on Opposite Sides	HFS6	3030	P571		
	NFS6	3050	P572		
	GF56	3070	P573		
	GF57	3090	P574		
	GF58	3110	P575		
	GF59	3130	P576		
	GF60	3150	P577		
	GF61	3170	P578		
	GF62	3190	P579		
	GF63	3210	P580		
One-Side Slot Three Flats	HFS6	3030	P571	Z6	d6.5
	NFS6	3050	P572		
	GF56	3070	P573		
	GF57	3090	P574		
	GF58	3110	P575		
	GF59	3130	P576		
	GF60	3150	P577		
	GF61	3170	P578		
	GF62	3190	P579		
	GF63	3210	P580		
Light Type	HFS6	3030	P571		
	NFS6	3050			