

Folding Door Units / Magnetic Catches for Folding Doors / Sliders for Folding Doors

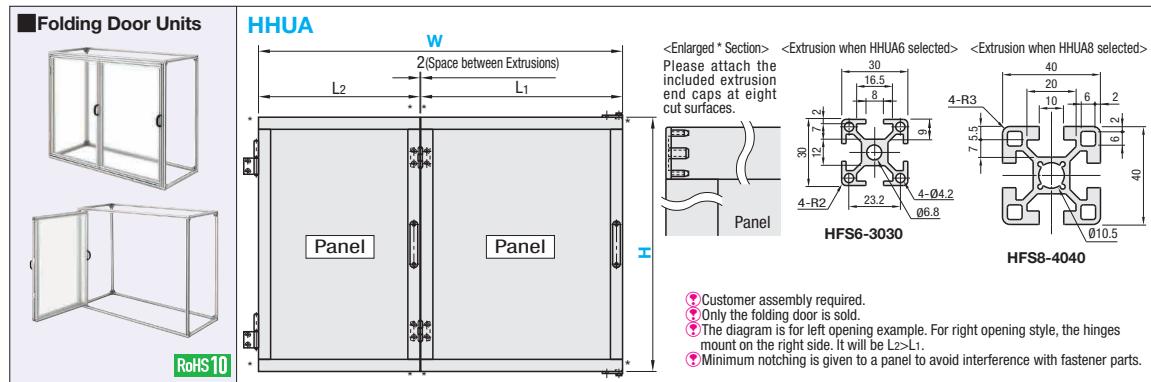

Part Number	Type	No.	Open/Close Direction	Panel Selection (Select a desired material and thickness from the codes below)	W (Width) 1mm Increment	H (Height) 1mm Increment	L1	L2	Components														
									Extrusion* Parts	Fastening Parts	Panel Clamps	Sliders for Folding Doors	Handle	Hinges (for Middle)	Hinges (for Fixing)	Extrusion End Cap							
HHUA	6	L (Left)	R (Right)	Acrylic (Clear)	AC	AC3	L2+28	W/2-15	HFS6-3030	HCUJ6	8	HSCFP3H-B	HSCFP3H-B	HFAFSHG	2	HHDF20-SST	2	HHP5N6-SST	2	HHPFLN6-SST	2	HFC6-3030-S	8
				Polycarbonate (Clear)	PC	PC3	W/2-15	L1+28	HSCFP3H-B	HSCFP3H-B	HFAFSHG	2	HHDF20-SST	2	HHP5N6-SST	2	HHPFLN6-SST	2	HFC6-3030-S	8			
	PET (Clear)	PY	PY3	500-1500	500-1000	HSCFP3H-B	HSCFP3H-B	HFAFSHG	2	HHDF20-SST	2	HHP5N6-SST	2	HHPFLN6-SST	2	HFC6-3030-S	8						
	Anti-static PVC (Clear)	ST	ST3	L2+46	W/2-24	HFS8-4040	HCUJ8	8	HSCFP3H-B	HSCFP3H-B	HFAFSHG	2	HHDF20-SST	2	HHP5N8-SST	2	HHPFLN8-SST	2	HFC6-4040-S	8			
8	L (Left)	R (Right)	No Panel	NN	NN3	W/2-24	L1+46	HFS8-4040	HCUJ8	8	HSCFP3H-B	HSCFP3H-B	HFAFSHG	2	HHDF20-SST	2	HHP5N8-SST	2	HHPFLN8-SST	2	HFC6-4040-S	8	
			No Panel	NN	NN3	W/2-24	L1+46	HSCFP3H-B	HSCFP3H-B	HFAFSHG	2	HHDF20-SST	2	HHP5N8-SST	2	HHPFLN8-SST	2	HFC6-4040-S	8				

Panel holders are included even with No Panel Type.

Ordering Example: Part Number - Panel - W - H
HHUA6L - PC - 1000 - 800

Part Number	W(mm)	H/Height		Panel Selection		Material Multiplier
		500-749	750-1000	AC	Acrylic (Clear)	
HHUA	6L	500-749		AC	Acrylic (Clear)	x1.0
		750-999		PC	Polycarbonate (Clear)	x1.2
		1000-1249		PY	PET (Clear)	x0.9
	8L	1250-1500		ST	Anti-static PVC (Clear)	x1.3
		500-749		AC3	Acrylic (Clear)	x0.9
		750-999		PC3	Polycarbonate (Clear)	x1.0
8R	1000-1249		PY3	PET (Clear)	x0.9	
	1250-1500		ST3	Anti-static PVC (Clear)	x1.1	
	No Panel		NN	No Panel	x0.6	
			NN3	No Panel	x0.6	

Example of Folding Door Assembly (Left Opening)

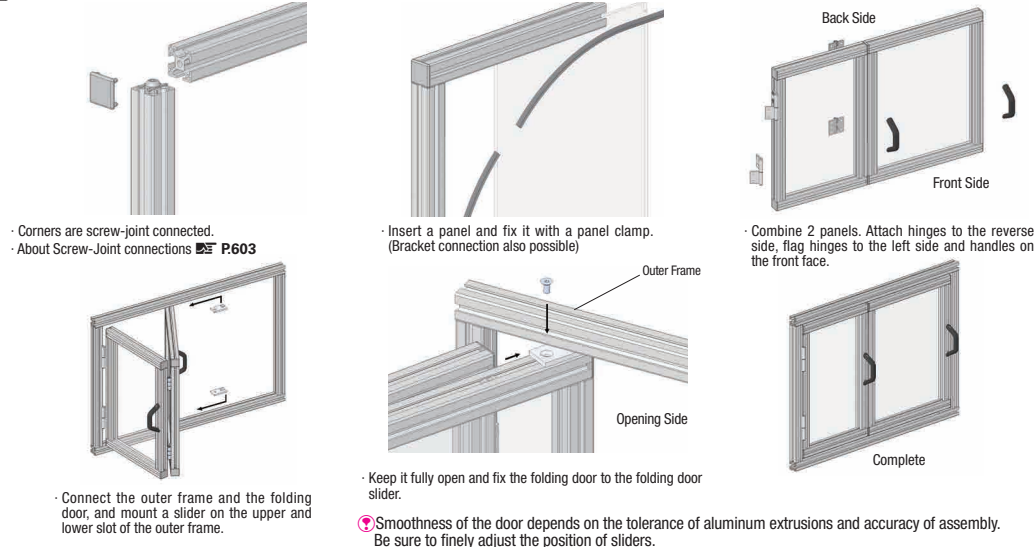

Clearance between HHUA and the Outer Frame Extrusions

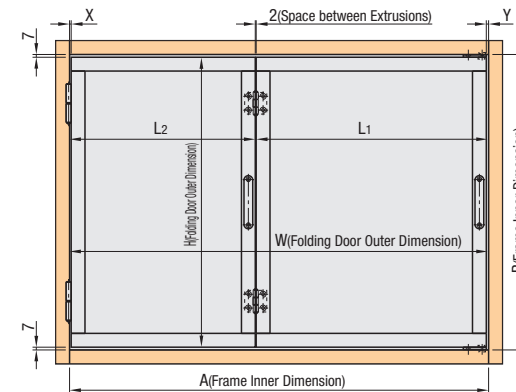

Folding Door Units	Type	No.	Outer Frame Extrusions												
			30 Square (HFS6)					40 Square (HFS8)							
			W Dimension	H Dimension	X Dimension	Y Dimension		W Dimension	H Dimension	X Dimension	Y Dimension				
HHUA	6	A-Y-X	B-14	3.5	7.5	6.5	5.5	-	-	-	-	-	-	-	-
		8	-	-	-	-	-	-	A-Y-X	B-14	4.5	11.5	9.5	7.5	

Magnetic Catches for Folding Doors

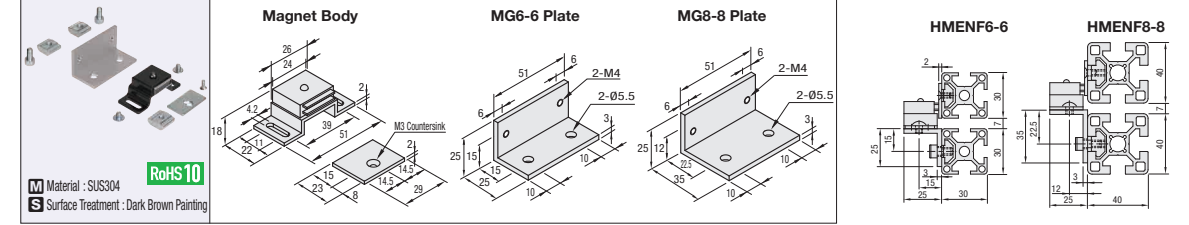

Part Number	Type	No.	Applicable Extrusion	Folding Door	Magnet Retention Force N(kgf)	Components						Unit Price	Volume Discount Rate					
						Magnet Side			Door Side (Extrusion Side)									
HMENF	6-6	8-8	30 Square	30 Square	29.4 (3)	MG6-6	Truss Screw M4-5	2	SCB5-10	2	HNTT6-5	2	M3-8	1	HNTT6-3	1	1 ~ 4 pc(s)	5-50
			40 Square	40 Square		MG8-8	Truss Screw M4-5	2	SCB5-12	2	HNTT8-5	2	HNTJ8-3	1				

Ordering Example: Part Number HMENF6-6

For orders larger than indicated quantity, please check with WOS.

Sliders for Folding Doors

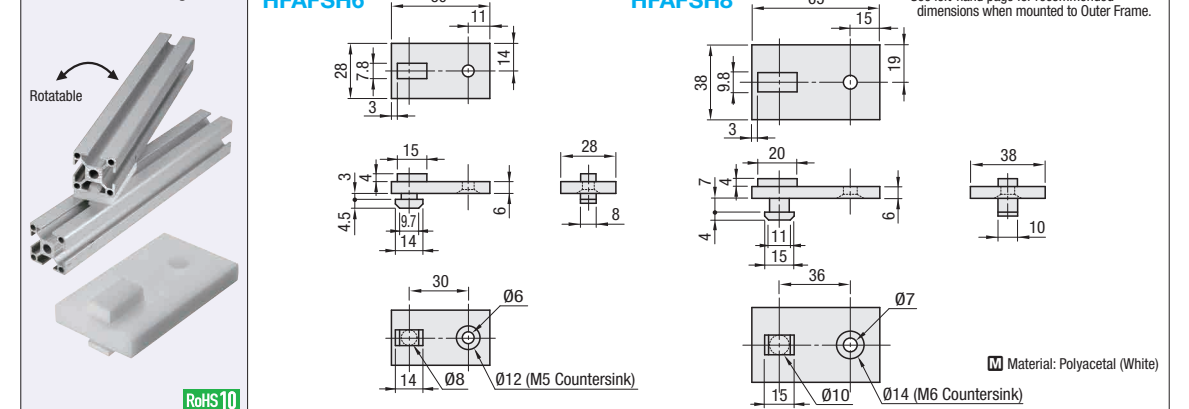

Part Number	Type	No.	Applicable Extrusion (Series)		Included Screw and Nut		Unit Price	Volume Discount Rate
			Folding Door Side Extrusion	Outer Frame Side Extrusion	Screw	Nut		
HFAFSH	6	8	HFS6	HFS6	SHFBS5-12	SHNTP6-5	1	1 ~ 49 pc(s)
			HFS8*	HFS8*	SHFBS6-15	SHNTP8-6	1	

* Cannot be used for HFS8-45, HFS8-50 and HFS8-60.

For orders larger than indicated quantity, please check with WOS.

Ordering Example: Part Number HFAFSH6



Details of Each Component

Part Number	Product Name	Page
HFS6-3030	30mm Sq. Alum. Extrusions	P571
HFS8-4040	40mm Sq. Alum. Extrusions	P631
HCJ	Screw Joints	P603
HSCP3H-B, HSCP5H-B	Panel Clamps	P789
HFAFSH	Sliders for Folding Doors	P856
HHDF	Handle	P827
HHPSN	Hinge	P805
HHPFLN(HHPFRN)	Flag Hinges	P812
HFC6-3030-S, HFC8-4040-S	Extrusion End Cap	P627

Imparting Folding Door

