

Leveling Mounts for Factory Frames / Table-Top Leveling Mounts

Note that, for some of the types shown here, order might be unable to be received by the MISUMI Indonesia offices.

Casters for Factory Frames Screw-In / Insertion Type

When mounting, select FFS203-8 (for M8) or FFS203-12 (for M12) on P884.

Leveling Mounts



NFJN
NFJNS (Stainless Steel)

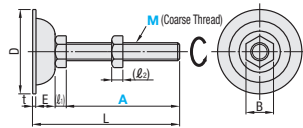

Threaded shaft can turn, and tilt 3~5°.

Type	Material	Surface Treatment
NFJN	SS400 Equivalent	Trivalent Chromate
NFJNS	SUS304	Electrolytic Polishing

M	D	(ℓ1)	(ℓ2)	E	B	t
8	38	5.5	6.5	11	13	1.6
12	60	8	10	18	19	2.0

RoHS10

Part Number Type	M-A	L	Allowable Vertical Load (kN)	Mass (g)	Unit Price	
					NFJN	NFJNS
NFJN NFJNS (Stainless Steel)	8 - 50	68.1	3.9	50		
	8 - 100	118.1		65		
	12 - 75	103	166			
	12 - 100	128	184			
	12 - 125	153	200			
12 - 150	178	219				



Alterations Part Number - A - (WC, WK, SC, WN)
NFJN8 - 50 - WC

Applicable to NFJN (SS400) only. No plating on alteration applied sections.

Alterations	Square Chamfering	Hex Chamfering	Wrench Flats	Hex Wrench Socket Machining

Code	WC	WK	SC	WN
	Ordering Code	WC	WK	SC
Spec.	M WC ℓ 12 8 10	M WK ℓ 12 8 10	M W ℓ1 SC 12 10 10 20	M WN ℓ 12 5 6

Ordering Example Part Number - A
NFJN12 - 100

Table-Top Leveling Mounts



Screws and pads are one-piece molded.

Type	Material		Surface Treatment
	Main Body	Screw	
NFB	PP Resin	SS400	Trivalent Chromate

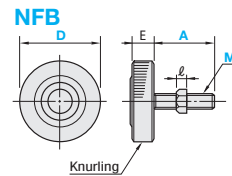

Part Number Type	M Coarse	A	ℓ	E	Allowable Load (kN)	Unit Price

Ordering Example Part Number - M - A
NFB30 - 8 - 31

Table-Top Leveling Mounts



KFB (Separate Type)

KFBR (Knurled Type)

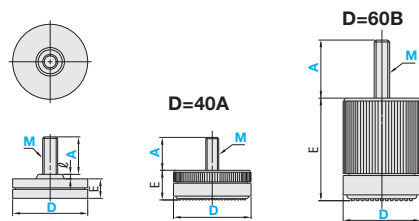

Type	Material		Surface Treatment
	Main Body	Bottom	Screw
KFB	ABS Resin		SWRM
KFBR	Polyamide	Polyurethane	Trivalent Chromate

Part Number Type	D	M (Coarse)	A	ℓ	E	Allowable Load (kN)	Mass (g)	Unit Price
KFBR	40A 60B	8 8	24 32	-	23 54	0.58 0.78	35 71	

Ordering Example Part Number - M - A
KFB40 - 8 - 25

When mounting, select FFS203-8 (for M8) or FFS203-12 (for M12) on P884. * Except FFHCHF, FFHCHFS



FFHCHF

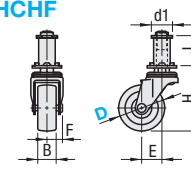

FFHCHFS (with Stopper)

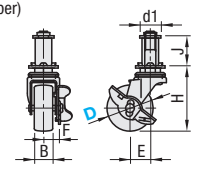

Usage: After inserting it into the frame, tightening the hexagonal part with a dedicated wrench (PFSP21, sold separately) will cause the rubber to expand, securing it from the inside of the pipe.

Material: SUS304

Part Number Type	Wheel Material Component / Color	d1	B	H	J	E	Wrench Width mm	Mass (kg)	Unit Price 1 ~ 100 pc(s)	
									R (Synthetic Rubber)	T (Conductive Rubber)
FFHCHF	R (Synthetic Rubber, Black)	50	20	70	22	19	0.20			
		75	25	100	28	21	0.51			
		100	23	129	31	0.68				
FFHCHFS (with Stopper)	T (Conductive Rubber, Black)	50	20	70	22	19	0.20			
		75	25	100	28	21	0.51			
		100	23	129	31	0.68				

Ordering Example Part Number - Wheel Material
FFHCHF50 - R

For orders larger than indicated quantity, please check with WOS.

Double Wheels Swivel Type



Type	Main Body		Wheel
	Material	Surface Treatment	Material (Color)
HCHA	Nylon	-	Nylon
HCHAS	Nylon	-	Nylon

HCHA
HCHAS (with Stopper)

HCHA 8-20, 8-30, 12-20, 12-30
Shape of HCHAS 8-20, 8-30, 12-20, 12-30

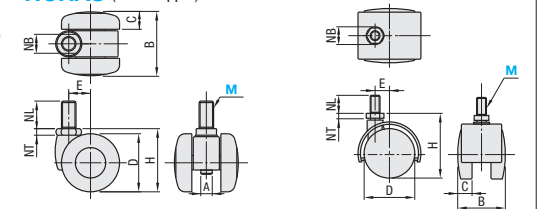

Part Number Type	M Coarse	Allowable Load (kgf) (N)	HCHA							HCHAS				
			D	H	A	B	C	E	NT	NL	Unit Price 1-9 pc(s)	Volume Discount Rate 10-50		
HCHA HCHAS (with Stopper)	8	20*	196	40	50	-	41	13	15	13	4	15		
		30*	294	50	60	-	45	14	18	14	4.5	12		
		40	396	40	43.5	7	44	12	15	14	4.5	12		
	12	60	594	50	57.5	8	49	14	17	17	6	14		
		100	990	60	68.5	-	41	13	15	19	4	15		
		150	1485	60	69	10	59	17.5	22	22	8	22		

Ordering Example Part Number - W
HCHA12 - 100

For * marked types, install and tighten the NB part with a wrench.
For orders larger than indicated quantity, please check with WOS.

Screw-In Swivel Casters



Type	Main Body		Wheel	Adjuster
	Material	Surface Treatment	Material	Surface Treatment
CMPAN	Nylon		Nylon	SS400
				Trivalent Chromate

① Tighten t1 nut to lock the main body thread.
② The t2 nut can be used to adjust the height of the leveling mount.

CMPAN

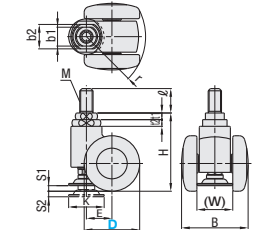

Part Number Type	Wheel Material	H	B	(W)	S1	S2	K	Mounting Screw Part M (Coarse) ℓ	Adj. Nut Size t1	t2	b1	b2	E (r)	Allowable Load (N)	Mass (g)	Unit Price	
																	CMPAN

Ordering Example Part Number - Wheel Material
CMPAN50 - N

Screw-In Casters



Type	Main Body		Wheel	Body Bearing
	Material	Surface Treatment	Material	Surface Treatment
FFS301	SPHC	Trivalent Chromate	Synthetic Rubber	Provided
FFS301S	SPHC	Trivalent Chromate	Synthetic Rubber	Provided

Tighten with a wrench for pipe inserts (PFSP21), (P903)

FFS301

FFS301S (with Stopper)

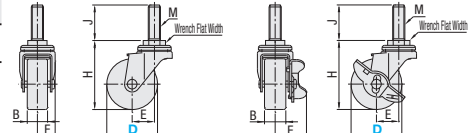

Part Number Type	Wheel Material Component / Color	M	B	F	H	J	E	Wrench Flat Width mm	Mass g	Allowable Load N	Unit Price
75	25	25.5	97	35	28	21	430	600			
FFS301S (with Stopper)	R (Synthetic Rubber)	50	20	30.9	68	22	19	190	300		
		75	25	43.3	97	35	28	21	485	600	

Ordering Example Part Number - Wheel Material
FFS301-75 - R
FFS301S-50 - R