

Antistatic PVC Plates

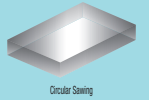

Cost-effective as antistatic type with high flame and chemical resistance.

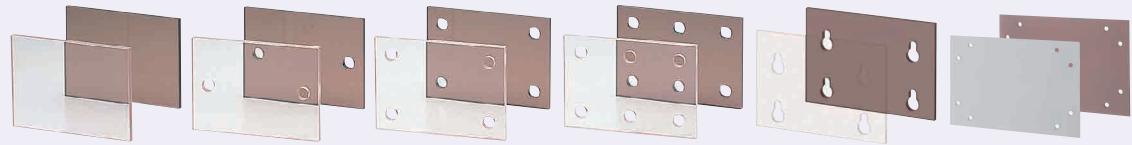

RoHS 10

ENBT (Antistatic PVC Plate, Transparent)
ENBBT (Antistatic PVC Plate, Smoke Brown)

Type	Operating Ambient Temperature
Antistatic PVC Plates	-30~60°C

Standard Type

Pre-drilled Type

2 Holes **2H**

4 Holes **4H**

6 Holes **6H**

8 Holes **8H**

8 Holes **8HV**

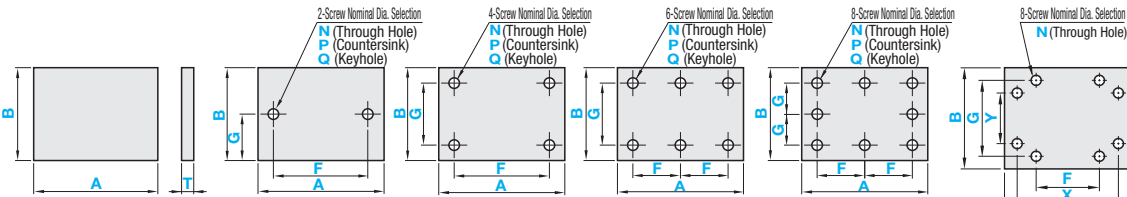

A ≥ B

Light Transmission: ENBT80%, ENBBT29%

Keyhole Reference Position

Keyhole Position

- For 2H, the center of diameter d₁ is consistent with G.
- For 4H and 6H, the center of G dimension is consistent with the center of B dimension.
- For 8H, the diameter d₁ center of the middle Keyhole is consistent with the center of B dimension.

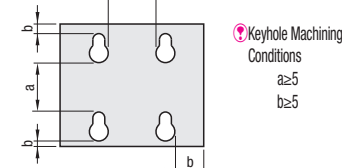
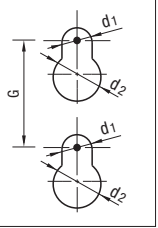

Keyhole Machining Conditions
 a ≥ 5
 b ≥ 5

Keyhole Details

Hole Machining Details

Accuracy Standards

T Dimension Tolerance ±0.5

Dimension Tolerance of A and B ±1.0

Use with flat washers (P.237) to prevent damage to the plastic.

Keyhole Nominal Dia.	5	6	8
d ₁	6	7	9
d ₂	14	16	20
h	11	12	15

Keyhole Details

Hole Machining Details

Accuracy Standards

T Dimension Tolerance ±0.5

Dimension Tolerance of A and B ±1.0

Use with flat washers (P.237) to prevent damage to the plastic.

Screw Nominal Dia.	3	4	5	6	8
d	3.5	4.5	5.5	6.5	9
d ₁	7.5	9.5	11.5	13.5	-
h	2	2.5	3	3.5	-

Standard Type

Pre-drilled Type

Part Number	1mm Increment		Selection	Part Number	1mm Increment		Selection	1mm Increment				Screw Nominal Dia. Selection					
	Type	A			B	Type		Number of Holes	A	B	T	F	G	X	Y	N (Through)	P (Countersink)
ENBT ENBBT	100-1100	100-900	3 5	ENBT ENBBT	2H 4H 6H 8H 8HV	100 1100	100 900	3 5	9~1091 (2H, 4H Type) 9~545 (4H, 6H Type) 9~445 (8H, 8HV Type)	5~895 (2H Type) 9~891 (4H, 6H Type) 9~445 (8H, 8HV Type)	-	-	-	3 4 5 6 8	3	4 5 6	5 6 8

- Dimension F Specification Range: For 2H and 4H, d(d₁)+5 ≤ F ≤ A-d(d₁)-5; for 6H and 8H, d(d₁)+5 ≤ F ≤ A/2-d(d₁)/2-2.5 ≤ F ≤ F
- Dimension G Specification Range: For 2H, d(d₁)/2+2.5 ≤ G ≤ B-d(d₁)/2-2.5; for 4H and 6H, d(d₁)+5 ≤ G ≤ B-d(d₁)-5; for 8H, d(d₁)+5 ≤ G ≤ B/2-d(d₁)/2-2.5. (d for through hole, d₁ for countersink)
- Dimension X Specification Range: d+5 ≤ X ≤ A/2-d/2-2.5
- Dimension Y Specification Range: d+5 ≤ Y ≤ B/2-d/2-2.5
- For 8HV: X-2d-F > 10, G-2d-Y > 10

Ordering Example **Standard Type**
 Part Number - A - B - T
ENBT - 955 - 825 - 5

Ordering Example **Pre-drilled Type**
 Part Number - A - B - T - F - G - Screw Nominal Dia.
ENBBT6H - 800 - 400 - 3 - F375 - G350 - N5

Standard Type Unit Price

Part Number	T	A	Unit Price							
			B100-200	B201-300	B301-400	B401-500	B501-600	B601-700	B701-800	B801-900
ENBT (Transparent)	3	100-200	-	-	-	-	-	-	-	-
		201-300	-	-	-	-	-	-	-	-
		301-400	-	-	-	-	-	-	-	-
		401-500	-	-	-	-	-	-	-	-
		501-600	-	-	-	-	-	-	-	-
		601-700	-	-	-	-	-	-	-	-
		701-800	-	-	-	-	-	-	-	-
		801-900	-	-	-	-	-	-	-	-
		901-1000	-	-	-	-	-	-	-	-
		1001-1100	-	-	-	-	-	-	-	-
ENBBT (Smoke Brown)	3	100-200	-	-	-	-	-	-	-	-
		201-300	-	-	-	-	-	-	-	-
		301-400	-	-	-	-	-	-	-	-
		401-500	-	-	-	-	-	-	-	-
		501-600	-	-	-	-	-	-	-	-
		601-700	-	-	-	-	-	-	-	-
		701-800	-	-	-	-	-	-	-	-
		801-900	-	-	-	-	-	-	-	-
		901-1000	-	-	-	-	-	-	-	-
		1001-1100	-	-	-	-	-	-	-	-

Type	Pre-drilled JPY Screw Nominal			Unit Price
	N (Through)	P (Countersink)	Q (Keyhole)	
2H				
4H				
6H				
8H				
8HV				

Pre-drilled Type Price = Standard Type Unit Price + Hole Machining Charge

(Ex.) Part Number - A - B - T - F - G - Screw Nominal Dia. >>

ENBT4H - 500 - 400 - 5 - F240 - G160 - N8 >>

(Standard Type Unit Price) + (Hole Machining Charge) = Pre-Drilled Type Price



Alterations Part Number - A - B - T - F - G - Screw Nominal Dia. - (XC, YC, CN... etc.)
ENBT4H - 500 - 400 - 3 - F300 - G300 - N6 - XC15, YC35

Alterations	Notching for Blind Joints of Aluminum Extrusions	Relief at Four Corners	Corner Cut
Code	F, E, J, K	CN	CCA, CCB, CCC, CCD
Spec.	Machines relief for blind joints of aluminum extrusions. Margin against thermal expansion of the plate is not taken into account. Longitudinal direction of notching is all on A dimension side. Ordering Code: F S 6 Extrusion Type Joint Type Notching Position (See the diagram above.)	CN=1mm Increment Machines relief at four corners. 5 ≤ CN ≤ 50 Ordering Code: CN=25 ... CN25	Cuts any corners. 5 ≤ Corner Cut ≤ 50 5mm Increment Ordering Code (Ex.) When the corners of A and D are cut by C5 ... CCA5-CCD5 Available for Standard Type only.

Alterations	Corner Radius	Hole Position from Left	Hole Position from Bottom
Code	CRA, CRB, CRC, CRD	XC	YC
Spec.	Adds radius to any corner. R = 5mm Increment (10 ≤ A(B)-R(2R)) 5 ≤ CRA, CRB, CRC, CRD ≤ 100 Ordering Code (Ex.) Adds R10 at the corner of A and C. CRA10-CRC10 Available for Standard Type only.	XC = 1mm Increment 5 ≤ XC ≤ 1086 (2H, 4H Type) d(d ₁)/2+2.5 ≤ XC ≤ A-F-d(d ₁)/2-2.5 (6H, 8H Type) d(d ₁)/2+2.5 ≤ XC ≤ A-2F-d(d ₁)/2-2.5	YC = 1mm Increment 5 ≤ YC ≤ 886 (4H, 6H Type) d(d ₁)/2+2.5 ≤ YC ≤ B-G-d(d ₁)/2-2.5 (8H Type) d(d ₁)/2+2.5 ≤ YC ≤ B-2G-d(d ₁)/2-2.5 Not available for 2H.