

# Flat Belt Conveyor High Power Type

## Center Drive, 3-Groove Frame (Pulley Dia. 30mm)

CE Compliant

\*The above compliance applies only for Single-phase 230V Motors.

Dedicated web site <http://fa.misumi.jp/cvs/>

The above site can be used to search for Conveyor components and their maintenance parts.

■ Up to 90W, Medium distance (up to 6m) transfer suited conveyor. The center drive is suitable for "Conveyor to Conveyor" transfer.



**CVSX**  
60W/90W Motor Type

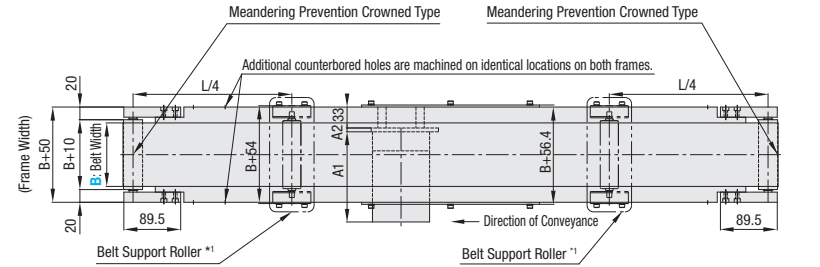

|                     | Frame         | Motor Cover | Pulley Holder |
|---------------------|---------------|-------------|---------------|
| M Material          | Aluminum      | Steel       | SS400         |
| S Surface Treatment | Clear Anodize | Paint       | Paint         |

### Frame Cross Section and Enlarged View (Symmetrical)

Carrying Surface Side

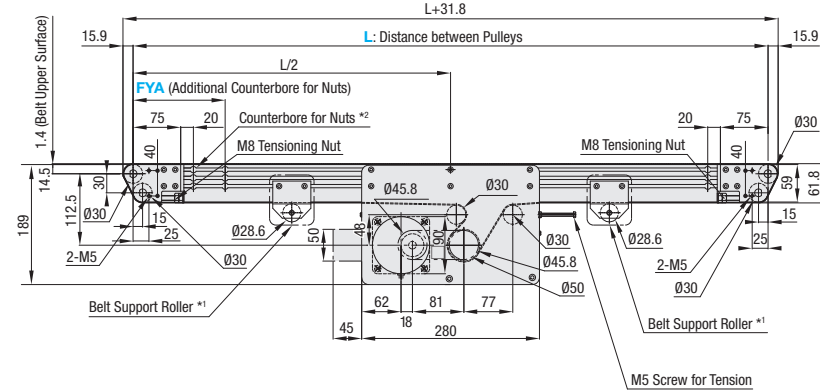
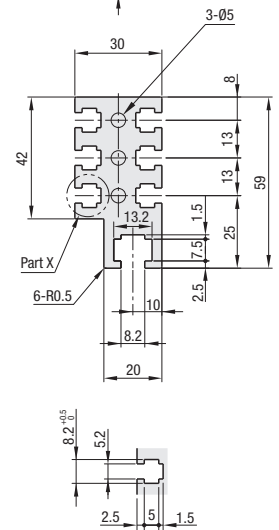

- \*1. When  $L \geq 4005$ , belt support rollers are mounted in the diagram locations. The layout is as shown in the diagram at the time of shipping but the drive section and belt support rollers can be moved.
- \*2. When  $L \leq 525$ , there will be no counterbored hole for nuts. However, each slot has 4 pre-inserted nuts provided.

- ⚠ The dimensions in the diagram is for Belt Specification H (0.9mm THK.). Note that belt thickness varies by Belt Specifications. For Belt Specifications, see P.1313~.
- ⚠ On some operating environments, conveyance failure may occur.

⚠ Compatible with JIS standard hex nuts.

### \*A Dimension (Motor Overall Length) Details

| Output (W) | Motor                |              | Reduction Ratio | A1    | A2 |
|------------|----------------------|--------------|-----------------|-------|----|
|            | Specification        | Manufacturer |                 |       |    |
| 60W        | Induction Motor      | Panasonic    | 5~180           | 180.0 | 6  |
|            |                      | Oriental     | 5~180           | 185.0 |    |
|            |                      | Taiwanese    | 5~75            | 182.6 |    |
|            | Variable Speed Motor | Oriental     | 90~180          | 191.6 |    |
|            |                      | Taiwanese    | 5~180           | 215.0 |    |
|            |                      | Taiwanese    | 5~75            | 194.6 |    |
| 90W        | Induction Motor      | Panasonic    | 5~180           | 195.0 | 6  |
|            |                      | Oriental     | 5~180           | 200.0 |    |
|            |                      | Taiwanese    | 5~75            | 195.6 |    |
|            | Variable Speed Motor | Oriental     | 90~180          | 204.6 |    |
|            |                      | Taiwanese    | 5~180           | 230.0 |    |
|            |                      | Taiwanese    | 5~75            | 209.6 |    |
|            |                      |              | 90~180          | 218.6 |    |

### Conveying Capacity

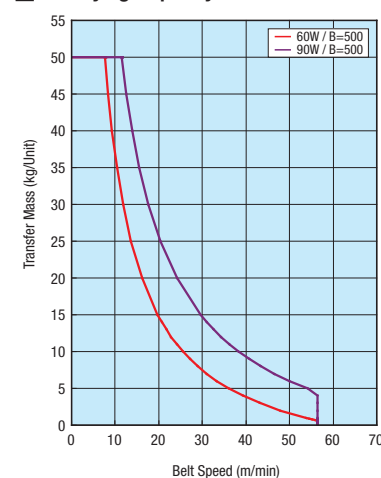

### Gearhead Reduction Ratio

\* May decrease depending on load condition.

| Gearhead Reduction Ratio | Belt Speed (m/min) |      |
|--------------------------|--------------------|------|
|                          | 50Hz               | 60Hz |
| 5                        | 47.1               | 56.5 |
| 7.5                      | 31.4               | 37.7 |
| 9                        | 26.2               | 31.4 |
| 12.5                     | 18.8               | 22.6 |
| 15                       | 15.7               | 18.8 |
| 18                       | 13.1               | 15.7 |
| 25                       | 9.4                | 11.3 |
| 30                       | 7.9                | 9.4  |
| 36                       | 6.5                | 7.9  |
| 50                       | 4.7                | 5.7  |
| 60                       | 3.9                | 4.7  |
| 75                       | 3.1                | 3.8  |
| 90                       | 2.6                | 3.1  |
| 100                      | 2.4                | 2.8  |
| 120                      | 2.0                | 2.4  |
| 150                      | 1.6                | 1.9  |
| 180                      | 1.3                | 1.6  |

| Part Number | B Selection                     | L 5mm Increment | Output (W) | Motor               |                            | Belt Specification   | FYA (Additional Counterbores) 5mm Increment | Motor Manufacturer Selection  |
|-------------|---------------------------------|-----------------|------------|---------------------|----------------------------|--|---|---|
|             |                                 |                 |            | Voltage (V)         | Specification              |  |   |   |
| CVSX        | 100<br>200<br>300<br>400<br>500 | 480-6000        | 60<br>90   | T100 (Single-phase) | IM (Induction Motor)       | 5 7.5 9 12.5 15<br>18 25 30 36 50<br>60 75 90 100 120<br>150 180 | 105<FYA<L-105                               | A (Panasonic Motor)<br>B (Oriental Motor)<br>C (Taiwanese Motor)<br>* SCM (Variable Speed Motor) is not selectable for A.<br>* For C, the conveyance speed may decrease by approx. 20%.<br>R (No Motor, Gearhead) |
|             |                                 |                 |            | T200 (Single-phase) | SCM (Variable Speed Motor) |  |   |   |
|             |                                 |                 |            | S200 (3-phase)      | IM (Induction Motor)       |  |   |   |
|             |                                 |                 |            | NV (No Motor)       | NM (No Motor)              |  |   |   |
|             |                                 |                 |            |                     | NH (No Gearhead)           |  |   |   |
|             |                                 |                 |            |                     |                            |  |   |   |

- ⚠ Connect the motor so that the belt rotates in the direction of conveyance. For connection diagram, and details of motor and inverter, see P.1301~.
- ⚠ When  $L \geq 2005$ , customers are to assemble.
- ⚠ Workpiece weighing over 10kg/unit might deform belt base plate.
- ⚠ When the unit length (L dim.) is 2000mm or less, this will be delivered as the finished product. For a unit over 2000mm, the product is delivered with frames unassembled and the customer is to assemble the unit by following instructions on the included assembly procedure manual. The assembly procedure manual can also be downloaded from our Conveyor Selection web site.
- ⚠ When "No motor, gearhead" is selected, the motor mounting hole pitch will vary depending on the motor's power rating. For the dimension details, see Technical Information in our Conveyor Selection web site.
- ⚠ When "No motor, gearhead" is selected, this unit will be delivered unassembled. The customer is to assemble the unit by following instructions on the included assembly procedure manual. See our Conveyor Selection site for assembly procedures and packaging details.
- ⚠ Purple Color Type of Belt is the Catalog Standard-Altered product. For details, see P.1313~.

| Belt Specification            | Standard Belt (Body Price Only)       | Optional Belt 1   | Optional Belt 2   | No Belt     |
|-------------------------------|---------------------------------------|---|---|-------------|
| General Purpose               | H (Green), W (White), HG (Green)      | -   | HY (Yellow Green), HBN (Sky Blue)   | J (No Belt) |
| For Sliding                   | G (Green), S (White)                  | -   | -   |             |
| For Inclined Transfer         | LG (Green), LW (White)                | -   | -   |             |
| Grip Type                     | -                                     | GG (Green), GW (White)                                  | GSN (Green)   |             |
| Oil Resistant                 | O (Navy Blue), OH (Green), OG (Green) | OW (White)  | ON (White)  |             |
| Non-adhesive                  | N (White), NS (White)                 | NB (Sky Blue), NBG (Lime Green), HH (Green), HW (White) | NWN (White), NSN (Sky Blue), NGN (Lime Green), HBG (Green), HBW (White), BW (White) |             |
| For Food Transfer             | F (White)                             | KW (White), KSB (Sky Blue), PHB (Sky Blue)              | PHN (Sky Blue), PWN (White), KWN (White)  |             |
| For Electronic Parts Transfer | D (Black), DS (Black)                 | -   | DG (Black)  |             |

- ⚠ For flat belt details, see P.1313~.
- ⚠ For Motor Manufacturer C (Taiwanese Motor), select either the H, W, G, S, D, F, O, N or J (No Belt) option.
- ⚠ Since only the transporting surface side is designed to be oil resistant, Oil Resistant Types are not useable on environments where it is very likely that oil adheres to the back face.

| Part Number | B   | Body Price 1~10 pc(s). |          |           |            |            |            |            |            |            |            |            |            |            |            |            |            |            |            |            |            |            |  |  |
|-------------|-----|------------------------|----------|-----------|------------|------------|------------|------------|------------|------------|------------|------------|------------|------------|------------|------------|------------|------------|------------|------------|------------|------------|--|--|
|             |     | L480-600               | L605-800 | L805-1000 | L1005-1200 | L1205-1400 | L1405-1600 | L1605-1800 | L1805-2000 | L2005-2200 | L2205-2400 | L2405-2600 | L2605-2800 | L3005-3000 | L3255-3500 | L3505-3750 | L3755-4000 | L4005-4250 | L4255-4500 | L4505-5000 | L5005-5500 | L5505-6000 |  |  |
| CVSX        | 100 |                        |          |           |            |            |            |            |            |            |            |            |            |            |            |            |            |            |            |            |            |            |  |  |
|             | 200 |                        |          |           |            |            |            |            |            |            |            |            |            |            |            |            |            |            |            |            |            |            |  |  |
|             | 300 |                        |          |           |            |            |            |            |            |            |            |            |            |            |            |            |            |            |            |            |            |            |  |  |
|             | 400 |                        |          |           |            |            |            |            |            |            |            |            |            |            |            |            |            |            |            |            |            |            |  |  |
|             | 500 |                        |          |           |            |            |            |            |            |            |            |            |            |            |            |            |            |            |            |            |            |            |  |  |

| Motor Spec. Price | Motor Output | Specification | A (Panasonic Motor) | B (Oriental Motor) | C (Taiwanese Motor) | R (No Motor, Gearhead) |
|-------------------|--------------|---------------|---------------------|--------------------|---------------------|------------------------|
|                   |              |               | 60W<br>90W          | IM<br>SCM          |                     |                        |

| Belt Spec. Price | Standard Belt | Optional Belt 1 | Optional Belt 2 | No Belt |
|------------------|---------------|-----------------|-----------------|---------|
|                  |               |                 |                 |         |

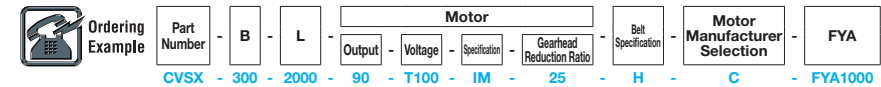

Alterations

Specify Drive Section Position  
Brackets for Speed Controller Included  
Post-Assembly Insertion Nuts Included  
Motors with Electromagnetic Brake  
Stands (Legs)

For details of Alterations, see P.1298~.