

High Torque Timing Pulleys - S2M

Compatible with S2M type from Mitsubishi Belting Ltd. as well as Bando Chemical Industries Ltd.

For e-Catalog non-standard products, see P.131.

For High Torque Timing Belts, see P.1499. For Idlers with Teeth, see P.1483.

Type	Belt Width			Material ¹⁾		Surface Treatment	Accessory ¹⁾ Set Screws
	4mm	6mm	10mm	Pulley	Flange		
HTPA	●	●	●	A2000 Aluminum Alloy	Aluminum Alloy	Clear Anodize	SUS304
HTPB	●	●	●			Black Anodize	
HTPK	●	●	●			Hard Clear Anodize ²⁾	
HTPN	●	●	●			Electroless Nickel Plating	
HTPT	●	●	●	S45C Equivalent	SPCC	-	SCM435 (Black Oxide)
HTPM	●	●	●			Black Oxide	
HTPP	●	●	●			Electroless Nickel Plating	
HTPS	●	●	●	SUS304	SUS304	-	SUS304

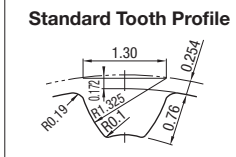

Standard Tooth Profile
Tooth groove dimensions slightly vary according to the number of teeth.
(Pitch:2.0mm)

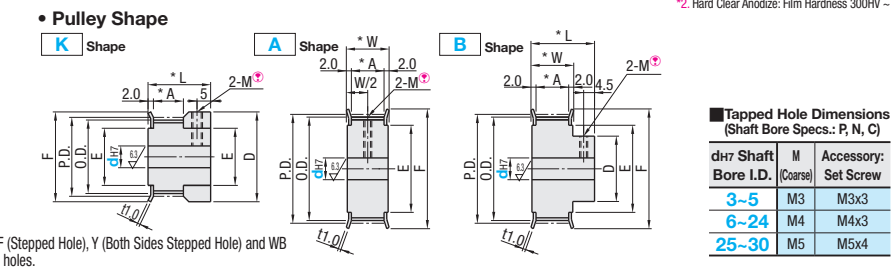

Tapped Hole Dimensions (Shaft Bore Specs.: P, N, C)

dH7 Shaft Bore I.D. (Coarse)	M	Accessory Set Screw
3-5	M3	M3x3
6-24	M4	M4x3
25-30	M5	M5x4

Flange is already swaged, and set screws are included with for Shaft Bore P, N and C. ¹⁾ The above material and accessory might be changed to the ones equivalent to the originals. ²⁾ Hard Clear Anodize: Film Hardness 300HV

Number of Teeth / Dimension

mm	Number of Teeth																				
	14	15	16	18	20	22	23	24	25	26	28	30	32	34	36	40	44	48	50	60	72
P.D.	8.91	9.55	10.19	11.46	12.73	14.01	14.64	15.28	15.92	16.55	17.83	19.10	20.37	21.65	22.92	25.46	28.01	30.56	31.83	38.20	45.84
O.D.	8.40	9.04	9.68	10.95	12.22	13.50	14.13	14.77	15.41	16.04	17.32	18.59	19.86	21.14	22.41	24.96	27.50	30.05	31.32	37.69	45.33
D	12	12	14	14	16	18	18	20	20	22	22	22	12	14	14	18	20	20	20	30	34
F	12	12	14	14	16	18	18	20	20	22	22	22	25	25	28	30	32	35	35	44	50
E	6	6	8	8	10	11	11	13	13	14	14	14	16	16	18	20	23	25	25	32	38

Belt Nominal Width / Dimension

mm	Nominal		
	S2M040	S2M060	S2M100
A	5	7	11
W	9	11	15
L	17	19	23

Shaft Bore Specs. Select shaft bore spec mark and each dim. from the table below. Surface treatment may not be applied to shaft bores.

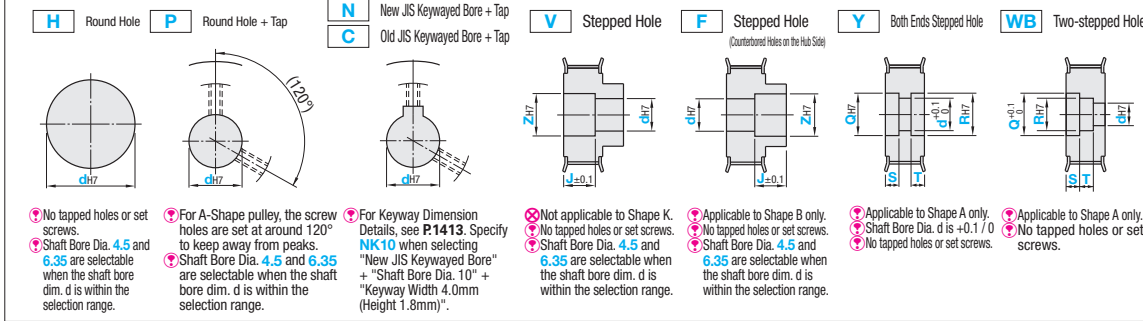

Part Number	Type	Number of Teeth	Type Nominal Width	Pulley Shape																				
				Shaft Bore Specs. "A" - "J": 1mm Increments "N": Selectable						Shaft Bore Specs. "B, K" - "T": 1mm Increments "V": Selectable														
				H(d)	P(d)	N(d), C(d)	V(d)	Y(d)	WB	H(d)	P(d)	N(d), C(d)	V(d)	Y(d)	WB									
Aluminum HTPA HTPB HTPK HTPN	A	14	3, 4																					
		15	3, 4																					
		16	3-5																					
		18	3-5																					
		20	3-6																					
		22	3-7																					
		23	3-7																					
		24	3-9																					
		25	3-9																					
		26	3-10																					
		28	3-10																					
		30	3-10																					
		Steel HTPT HTPM HTPP	A	32	4-12	4-10	8	4-10	6-12															
				34	4-12	4-10	8, 10, NK10	4-10	6-12															
36	4-14			4-10	8, 10, NK10	4-12	6-14																	
40	4-16			4-12	8, 12	4-14	6-16																	
44	5-19			5-15	8-13	5-17	7-19																	
48	5-21			5-17	8-16	5-19	7-21																	
50	5-21			5-17	8-16	5-19	7-24																	
60	5-28			5-24	8-22	5-26	7-28																	
72	5-34			5-30	8-26	5-32	7-34																	
Stainless Steel HTPS	B			14																				
				15																				
				16																				
				18																				
				20																				
		22																						
		23																						
		24																						
		25																						
		26																						
		28																						
		30																						
		32																						
		34																						
36																								
40																								
44																								
48																								
50																								
60																								
72																								

Shaft Bore Dia. 9 is not available for Shaft Bore Specs. N. Shaft Bore Dia. 4.5 and 6.35 are selectable for Shaft Bore Specs. H, P, V and F. Shaft Bore Dia. 8, 11, 13, 14, 17, 21-26 are not available for Shaft Bore Spec. C.

Ordering Example: Part Number - Pulley Shape - Shaft Bore Specs., I.D. - Z - J - Q - R - S - T

(Shaft Bore Specs.: H, P, N, C) HTPA48S2M040 - B - N10

(Shaft Bore Specs.: V, F) HTPA60S2M060 - B - V10 - Z17 - J14.2

(Shaft Bore Specs.: Y, WB) HTPA36S2M100 - A - Y6 - Q10 - R10 - S3 - T3

Number of Teeth	Body Price										Shaft Bore Machining Charge (Body Price +)				
	HTPA (x1.0) S2M040	HTPB, HTPK (x1.1) S2M060	HTPN (x1.2) S2M100	HTPT (x1.0) S2M040	HTPM (x1.05) S2M060	HTPP (x1.15) S2M060	HTPS (x1.0) S2M040	HTPS (x1.0) S2M060	HTPA, HTPB, HTPK, HTPN, HTPM, HTPP P Hole	HTPS P Hole	HTPS N, C, V, F Hole	HTPS Y, WB Hole	HTPS P Hole	HTPS N, C, V, F Hole	HTPS Y, WB Hole
14															
15															
16															
18															
20															
22															
23															
24															
25															
26															
28															
30															
32															
34															
36															
40															
44															
48															
50															
60															
72															

Alterations Part Number - Pulley Shape - Shaft Bore Specs., I.D. - Z - J - Q - R - S - T - (KC90... etc.)

HTPM48S2M040 - B - H10 - NFC

Alterations	Set Screw Angle	Flange Not Swaged	Flange Swaged on One Side	Flange Cut
Code	KC90	NFC	RFC, LFC	FC
Spec.	Changes an angle of set screw to 90°. For A-Shape pulley, the screw holes are set at around 90° to keep away from peaks.	(Flange 2 pcs. Included) [Ordering Code] NFC	(Flange 1 pc. Included) [Ordering Code] RFC [Ordering Code] LFC	Cut the flange O.D. in 0.5mm increment. [Ordering Code] FC17

Alterations	Retaining Ring Groove	Adds taper for retaining bearing	Hub Shortening	Tapped Hole Dimensions
Code	SRG	BTC	BC	TPC
Spec.	Retaining Ring Groove applicable to the shaft dia. of stepped hole is machined. Retaining Ring Groove Dim. P1413 SRG+0.1 (Specify SRG) 2.5-10mm 0.5mm increments Minimum Thickness: 2mm Applicable to Shaft Bore Specs. V and F only. Standards of retaining ring groove for Z dim. is applied. n:J-SRG-m [Ordering Code] SRG7	Add taper for retaining bearing inner ring [Ordering Code] BTC4-TL1.5	Cuts the hub length in 0.5mm increment. [Ordering Code] BC6.5	[Ordering Code] TPC5

Alterations	Side Tapped Hole	Side Through Hole	Side Counterbored
Code	QTC, QFC, QSC	KTC, KFC, KSC	ZTC, ZFC, ZSC
Spec.	Machines tapped hole on the side surface of hub side. [Ordering Code] QTC28-M4 [Ordering Code] QFC28-M4 [Ordering Code] QSC28-M4	Machines through hole on the side surface. [Ordering Code] KTC28-K4.5 [Ordering Code] KFC28-K4.5 [Ordering Code] KSC28-K4.5	Machines counterbored hole on the side surface. [Ordering Code] ZTC28-Z4 [Ordering Code] ZFC28-Z4 [Ordering Code] ZSC28-Z4