

# One-Touch Block Chains

Straight

Registration of a design pending

■ **Features:** Chain removal is easy. More economical than conventional products as SUS pins are unnecessary.



Part Number		Specification	Material	Color	Sliding Friction Coefficient f1	Operating Temp. (°C)
Standard	Attachment					
CHER	CHEA	General Use	POM	White	0.14~0.18	-5~65
CHERS	CHEAS	Extra Low Friction	POM + Lubricant	Cream	0.12~0.15	-5~65
CHERC	CHEAC	Conductivity, Heat Resistant	POM + Glass Fiber	Black	0.20~0.24	-20~120
CHERY	CHEAY	Chemical Resistant	Fluororesin	Translucent	0.18~0.22	-20~80

■ **Standard**

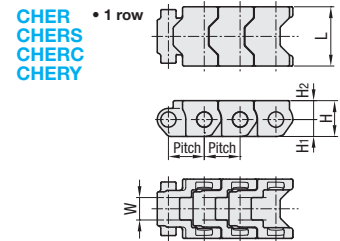

■ **Attachment**

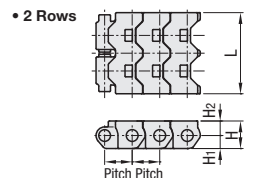
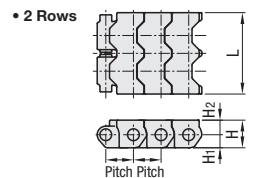
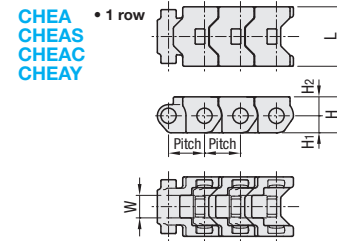

RoHS 10

■ **Allowable Tension and Reference Weight**

Nominal	Allowable Tension (N)				Reference Weight (kg/m)
	CHEA	CHEAS	CHEAC	CHEAY	
40	390	320	460	380	0.28
40W	390	320	460	380	0.47

- How to Select Applicable Chains **P.1578**
- For Sprockets applicable to Chains with 40W Nominal, see **P.1585**
- Since the bending angle of chain is predetermined, specify the mating sprocket with the number of teeth, 14 or more.
- For attachment, use with Flap Plates (**P.1580**) in combination.
- For Allowable Tension and Corrosion Resistance List, see **P.1577**
- May have scratches when links are removed.

Part Number		Number of Links	Number of Rows	Pitch	W	L	H <sub>1</sub>	H <sub>2</sub>	H
Type	Nominal								
Standard CHER CHERS CHERC CHERY	Attachment CHEA CHEAS CHEAC CHEAY	40	1	12.7	7.95	21	6	6.7	12.7
		Number of Links Configurable 1~99							
		40W	2	14.4	37.4				
		Number of Links Fixed 20 100 Number of Links Fixed (disconnected) 20-NA							

For Number of Links 20NA (disconnected), links are not connected. Use them to adjust amount or for repairing.

■ **Number of Links Configurable**

Part Number	Type	Nominal	Unit Price (Unit : 20 Links)				Unit Price (Unit : 100 Links)			
			CHEA	CHEAS	CHEAC	CHEAY	CHEA	CHEAS	CHEAC	CHEAY
Standard CHER CHERS CHERC CHERY	Attachment CHEA CHEAS CHEAC CHEAY	40								
		40W								

■ **Number of Links Configurable**

Part Number	Type	Nominal	Unit Price (Unit : 1 Link)			
			CHEA	CHEAS	CHEAC	CHEAY
Standard CHER CHERS CHERC CHERY	Attachment CHEA CHEAS CHEAC CHEAY	40				
		40W				

Number of Links Fixed Type is more economical.

Ordering Example  
Part Number - Number of Links  
CHER40 - 100  
CHEA60 - 93

Example

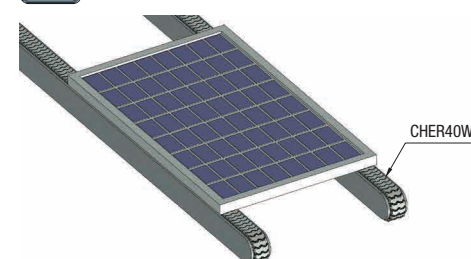

# One-Touch Table Top Chains

Thin, Straight Running

Registration of a design pending

■ **Features:** Available for wide surface transfer by combination. Two-row type is available as a set. Three or more rows are also connectable.

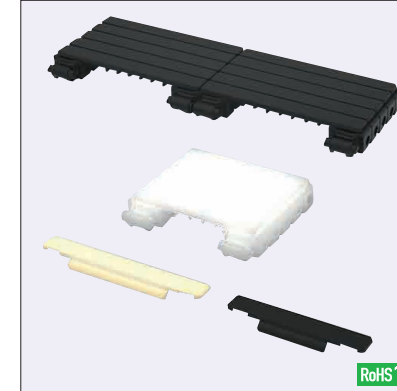

Part Number		Specification	Material	Color	Sliding Friction Coefficient f1	Operating Temp. (°C)
Set	Flap					
CHEF	CHEP	General Use	POM	White	0.14~0.18	-5~65
CHEFS	CHEPS	Extra Low Friction	POM + Lubricant	Cream	0.12~0.15	-5~65
CHEFC	CHEPC	Conductivity, Heat Resistant	POM + Glass Fiber	Black	0.20~0.24	-20~120
CHEFY	CHEPY	Chemical Resistant	Fluororesin	Translucent	0.18~0.22	-20~80

■ **Thin Table Top Chain Set**

CHEF  
CHEFS  
CHEFC  
CHEFY

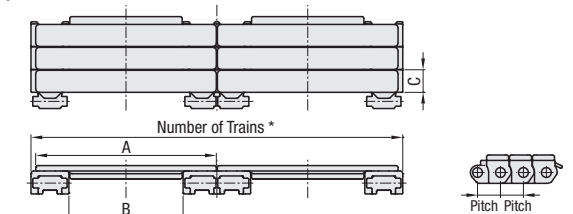

■ **Flap Plate**

CHEP  
CHEPS  
CHEPC  
CHEPY

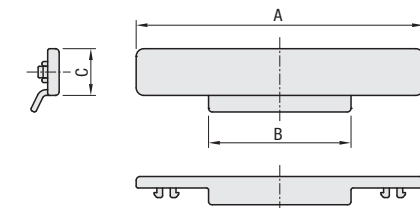

■ **Set Parts List (Specification: For General Use)**

Set Number	Part Number	Nominal	
		40	40W
(1)	CHEA40	2 pcs.	2 pcs.
(2)	CHEA40W	-	1 pc.
*(3)	CHEP40-75	1 pc.	2 pcs.
*(4)	CHEP40-100	1 pc.	2 pcs.

\*For A75, (3) is applicable; for A100, (4) is applicable.

■ **Allowable Tension and Reference Weight**

Nominal	Allowable Tension (N)				Reference Weight (kg/m)	
	CHEF	CHEFS	CHEFC	CHEFY	A75	A100
40	390	320	460	380	0.86	0.94
40W	390	320	460	380	1.65	1.81

- How to Select Applicable Chains **P.1578**
- For Sprockets applicable to Chains with 400W Nominal, see **P.1585**
- Since the bending angle of chain is predetermined, specify the mating sprocket with the number of teeth, 14 or more.
- A set comes with Flap Plates and Narrow One-Touch Table Top Chains Attachment Type (**P.1579**).
- For Allowable Tension and Corrosion Resistance List, see **P.1577**
- May have scratches when links are removed.

Part Number	Type	Nominal	A	Number of Links	Number of Rows	Pitch	B	C
40W	100	Number of Links Fixed 20 100 Number of Links Fixed (disconnected) 20-NA						
					2			

For Number of Links 20NA (disconnected), links are not connected. Use them to adjust amount or for repairing.

■ **Number of Links Configurable**

Part Number	Type	Nominal	A	Unit Price (Unit : 20 Links)				Unit Price (Unit : 100 Links)			
				CHEF	CHEFS	CHEFC	CHEFY	CHEF	CHEFS	CHEFC	CHEFY
Set CHEF CHEFS CHEFC CHEFY		40	75								
				100							
		40W	75								
			100								

How to Order  
Please order in combination with "Number of Links Fixed Type" and "Number of Links Fixed Type (disconnected)" or "Number of Links Configurable Type".

■ **Number of Links Configurable**

Part Number	Type	Nominal	A	Unit Price (Unit : 1 Link)			
				CHEF	CHEFS	CHEFC	CHEFY
Set CHEF CHEFS CHEFC CHEFY		40	75				
				100			
		40W	75				
			100				

Number of Links Fixed Type is more economical.

Ordering Example  
Part Number - A - Number of Links  
CHEF40 - 75 - 100  
CHEP40 - 100 - 23

Example

