

Locating Pins - Large Flat Head

Threaded

For products uncovered by e-Catalog Standard, see P.131.

Features: Large Flat Head, Press Fit + Lock Nut Type. Improved maintainability compared to Press Fit Type.

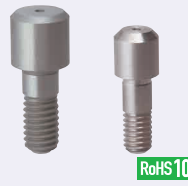

RoHS 10

Material No.	Material	Surface Treatment	Hardness	Type		
				P Selectable	P, L, B Configurable	P, L, B, ML Configurable
(1)	SKS3 Equivalent	-	Treated Hardness: 60~63HRC	JPFNB	FPFNA	FPFNLA
(2)	SKS3 Equivalent	Hard Chrome Plating	Treated Hardness: 50~55HRC Plating Hardness: 750HV -	-	GFPFNA	GFPFNLA
(3)	SKS3 Equivalent	-	-	-	BFPFNA	-
(4)	SUS304*	-	-	SJPFNB	SFPFNA	SFPFNLA
(6)	SUS440C or 13Cr stainless	-	Treated Hardness: 50~55HRC	CJPFNB	CFPFNA	CFPFNLA

* For P Selectable Type, it is SUS304 equivalent.

P dim. Tolerance Table

P	h6
3.50-6.00	0 -0.008
6.01-10.00	0 -0.009
10.01-18.00	0 -0.011
18.01-30.00	0 -0.013

Polished, centering hole is sometimes not available for SUS304.
SUS440C or 13Cr stainless has an identification groove at any position on D part.

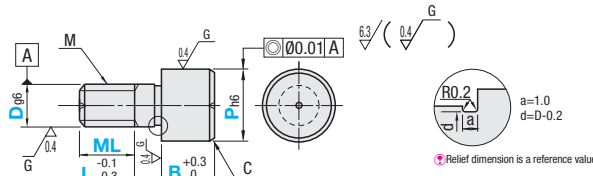

P Selectable

Part Number		D	D dim. Tolerance g6	P Selection				L	B	C	M (Coarse)	* Tightening Torque N·cm	ML
Type	D			4	5	6	8						
JPFNB SJPFNB CJPFNB	3	3	-0.002 -0.008	4	5	6	2	3	0.5	M3	98	4.5	
	4	4	-0.004 -0.012	5	6	8	2	4	1	M4	225	6	
	5	5	-0.004 -0.012	6	8	9	3	5	1	M5	461	7.5	
	6	6	-0.005 -0.014	8	9	10	3	5	1.5	M6	784	9	
8	8	8	-0.005 -0.014	9	10	12	5	6	1.5	M8	1911	12	

P, L, B Configurable

Part Number		D	D dim. Tolerance g6	P			L	B	C	M (Coarse)	* Tightening Torque N·cm	ML
Type	D			0.01mm Increment	1mm Increment	0.1mm Increment						
FPFNA GFPFNA BFPFNA SFPFNA CFPFNA	3	3	-0.002 -0.008	3.50~8.00	2~6	3.0~10.0	0.5	M3	98	4.5		
	4	4	-0.004 -0.012	4.50~8.00	2~8	4.0~10.0	1	M4	225	6		
	5	5	-0.004 -0.012	5.50~8.00	3~10	4.0~15.0	1	M5	461	7.5		
	6	6	-0.005 -0.014	6.50~10.00	3~10	4.0~15.0	1.5	M6	784	9		
	8	8	-0.005 -0.014	8.50~15.00	5~10	5.0~30.0	1.5	M8	1911	12		
	10	10	-0.006 -0.017	11.00~17.00	5~15	6.0~30.0	2	M10	3783	15		
	12	12	-0.006 -0.017	13.00~20.00	5~15	6.0~30.0	2	M12	6605	18		
	16	16	-0.007 -0.020	17.00~27.00	5~20	7.0~30.0	3	M16	16366	24		
20	20	-0.007 -0.020	22.00~30.00	5~20	10.0~30.0	3	M20	32928	30			

P, L, B, ML Configurable Thread length (ML) is configurable within the range between Mx1 and Mx3 (max.).

Part Number		D	D dim. Tolerance g6	P			L	B	C	M (Coarse)	* Tightening Torque N·cm
Type	D			0.01mm Increment	1mm Increment	0.1mm Increment					
FPFNLA GFPFNLA SFPFNLA CFPFNLA	3	3	-0.002 -0.008	3.50~6.00	2~6	3.0~10.0	3~9	0.5	M3	98	
	4	4	-0.004 -0.012	4.50~7.00	2~8	4.0~10.0	4~12	1	M4	225	
	5	5	-0.004 -0.012	5.50~8.00	3~10	4.0~10.0	5~15	1	M5	461	
	6	6	-0.005 -0.014	6.50~10.00	3~10	4.0~12.0	6~18	1.5	M6	784	
	8	8	-0.005 -0.014	9.00~13.00	5~10	5.0~15.0	8~24	1.5	M8	1911	
	10	10	-0.006 -0.017	11.00~15.00	5~15	6.0~20.0	10~30	2	M10	3783	
	12	12	-0.006 -0.017	13.00~16.00	8~15	6.0~20.0	12~30	2	M12	6605	
	16	16	-0.007 -0.020	17.00~25.00	8~20	7.0~20.0	16~40	3	M16	16366	
20	20	-0.007 -0.020	22.00~30.00	10~20	10.0~20.0	20~40	3	M20	32928		

* The tightening torque (ref. value) for hardened products is strength class 8.8. (See technical data on P.2365.) Not applicable when using locking materials or lock washers.

Ordering Example

Part Number	P	L	B	ML
JPFNB3	- 5			
FPFNA5	- P7.80	- L8	- B4.0	
FPFNLA8	- P10.00	- L5	- B5.0	- ML8

P Selectable

D	Unit Price		
	(1)Treated SKS3 JPFNB	(4)SUS304 SJPFNB	(6)SUS440C or 13Cr stainless CJPFNB
3			
4			
5			
6			
8			

P, L, B Configurable

D	Unit Price				
	(1)Treated SKS3 FPFNA	(2)Hard SKS3 GFPFNA	(3)SKS3 BFPFNA	(4)SUS304 SFPFNA	(6)SUS440C or 13Cr stainless CFPFNA
3					
4					
5					
6					
8					
10					
12					
16					
20					

P, L, B, ML Configurable (Unit price in the table is when Mx1≤ML<Mx1.5. For price calculation, refer to the table on the right.)

D	Unit Price			
	(1)Treated SKS3 FPFNLA	(2)Hard SKS3 GFPFNLA	(4)SUS304 SFPFNLA	(6)SUS440C or 13Cr stainless CFPFNLA
3				
4				
5				
6				
8				
10				
12				
16				
20				

Price of Threaded P, L, B, ML Configurable Type

Price is determined by ML length.

ML	Unit Price (Round off to JPY digit)
Mx1≤ML<Mx1.5	
Mx1.5≤ML<Mx2	
Mx2≤ML<Mx2.5	
Mx2.5≤ML<Mx3	

Alterations Part Number - P - L - B - ML - (RC, CN, RAC, LAC)
FPFNLA10 - P1200 - L5 - B9.0 - LAC

Alterations	Sphere Tip	C Chamfered Size	Hex Socket Machining	Wrench Hole Machining
	RC (R0.5)	C0.5 or less		
Code	RC	CN	RAC	LAC
Spec.	Changes the relief to R0.5. (Ordering Code) RC Applicable when P-D≥2 Combination with RAC or LAC is not available.	Changes C Chamfering at P dimension part to 0.5 or less.	Machines hex sockets. (Ordering Code) RAC Applicable when D≥6 Applicable to P, L, B Dimension Configurable Type only. Combination with RC or LAC is not available.	Machines wrench holes. (Ordering Code) LAC Applicable when D≥6 Applicable to P, L, B Dimension Configurable Type only. Combination with RC or RAC is not available.