

SUCTION CUP

SUCTION CUP

-SINGLE / DOUBLE / THREE-LAYER SUCTION CUP-

Single-layer Suction Cup



M	Material	H	Hardness	Operating temp. range (°C)	Color
	Silicone rubber		50-55	-40~+220	Translucent

10PACK—MVSHA

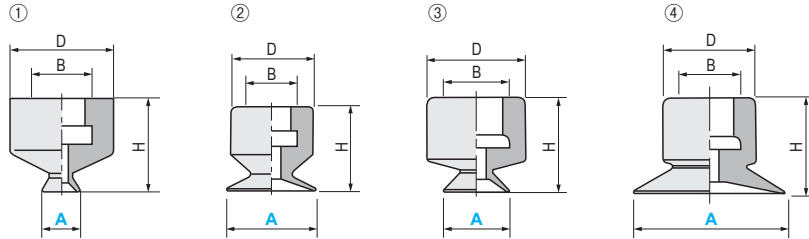

⚠ This product is a vacuum suction part. It has direct contact with the fittings through the suction cup holder. It is suitable to assemble with fixture products.

Double-layer Suction Cup



M	Material	H	Hardness	Operating temp. range (°C)	Color
	Silicone rubber		50	-40~+220	Translucent

10PACK—MVSHB

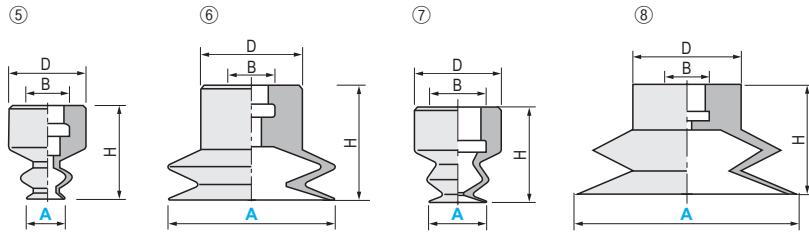

⚠ This product is a vacuum suction part. It has direct contact with the fittings through the suction cup holder. It is suitable to assemble with fixture products.

Three-layer Suction Cup



M	Material	H	Hardness	Operating temp. range (°C)	Color
	Silicone rubber		50-55	-40~+220	Translucent

10PACK—MVSHC

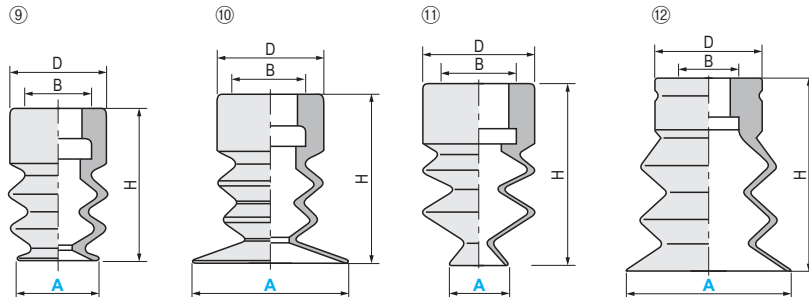

⚠ This product is a vacuum suction part. It has direct contact with the fittings through the suction cup holder. It is suitable to assemble with fixture products.



Part Number	No.	A	B	D	H	Drawing No.	Applicable metal fittings type	
10PACK—MVSHA	S2	1	2	7	11	①	4PACK—MVFS 4PACK—MVFST	
	S4	1	4	7	11			
	S6	1	6	7	11			
	S8	1	8	7	11			
	S10	1	10	7	11			
	S12	1	12	7	11			
	S15	1	15	7	11	②		
	S20	1	20	7	12			
	S25	1	25	7	11			
	S30	1	30	7	13			
	M4	1	4	11	15			③
	M6	1	6	11	15			
	M8	1	8	11	15			
	M10	1	10	11	15			
	M12	1	12	11	15			
	M15	1	15	11	16	④		
	M20	1	20	11	16			
	M25	1	25	11	15			
M30	1	30	11	16				
M40	1	40	11	17				
M50	1	50	11	20				
10PACK—MVSHB	S4	2	4	7	12	⑤	4PACK—MVFS 4PACK—MVFST	
	S6	2	6	7	12			
	S8	2	8	7	12			
	S10	2	10	7	12			
	S12	2	12	7	12			
	S15	2	15	7	15			
	S20	2	20	7	15	⑥		
	S25	2	25	7	15			
	S30	2	30	7	15			
	M6	2	6	11	15			⑦
	M8	2	8	11	15			
	M10	2	10	11	15			
	M12	2	12	11	15			
	M15	2	15	11	15			
	M20	2	20	11	15	⑧		
	M25	2	25	11	15			
	M30	2	30	11	18			
	M35	2	35	11	18			
M40	2	40	11	23				
M50	2	50	11	24				
10PACK—MVSHC	S6	3	6	7	10	⑨	4PACK—MVFS 4PACK—MVFST	
	S8	3	8	7	10			
	S10	3	10	7	10			
	S12	3	12	7	10			
	S15	3	15	7	10			
	M8	3	8	11	15	⑪		
	M10	3	10	11	15			
	M12	3	12	11	15			
	M15	3	15	11	15			
	M20	3	20	11	15			
	M25	3	25	11	17		⑫	
	M30	3	30	11	17			
M40	3	40	11	20				
M50	3	50	11	20				



Part Number — No.
10PACK—MVSHA — S2—1



Quotation



Quotation

REMOVAL
RELATED PRODUCTS