

# PRECISION LEADER PINS WITH SPIRAL VENT

— STRAIGHT • SPIRAL GROOVE PRESS-FIT LENGTH DESIGNATION TYPE • PRESS-FIT DIAMETER • LENGTH DESIGNATION TYPE —

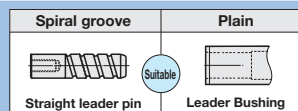

Ⓜ Non JIS material definition is listed on P.1351 - 1352

RoHS



**GPSLOC** (Press-fit diameter Dm5 • length designation • spiral groove fixed length)  
**GPSLOF** (Press-fit diameter Dm5 • length designation • spiral groove length designation)  
**GPS-XLOC** (Press-fit diameter DK designation • length designation • spiral groove fixed length)  
**GPS-XLOF** (Press-fit diameter DK designation • length designation • spiral groove length designation)

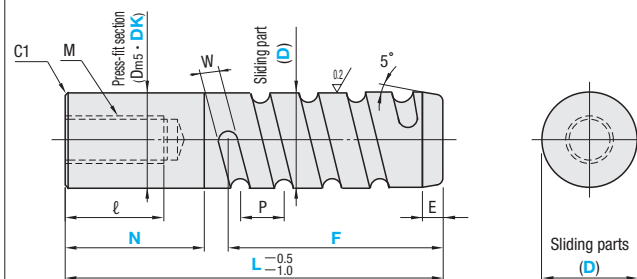

Sliding parts D	Press-fit section Dm5	GPSLOC GPSLOF	M×Pitch	ℓ	E	W
8	-0.015	8	+0.012	M 5×0.8	10	3
10	-0.020	10	+0.006			4
12	-0.020	12	+0.015	M 6×1.0	12	
13	-0.025	13	+0.007			
16		16		M 8×1.25	16	5
20		20				
25	-0.025	25	+0.017	M12×1.75	24	3
28	-0.030	28	+0.008			
30		30		M16×2.0	32	8
32	-0.030	32	+0.020			
35	-0.035	35	+0.009			
40	-0.030	40	+0.009	M20×2.5	40	
50	-0.040	50				
60	-0.030 -0.050	60	±0.024 ±0.011			

L	P	F dimension	GPSLOC • GPS-XLOC
40~70	10		
75~120	15	When L-N > L/2	F = L/2
125~180	20	When L-N ≤ L/2	F = L - (N+10)
185~300	25		
305~500	30		

- Ⓜ Recommended mold temperature for the usage of a precision leader pin and bushing is 80°C or less because of a little clearance between them. (☞ P.878)
- Ⓜ Oil groove part might not be colored by heat treatment. Despite appearance differences, it can be used without any problem.

☞ SUJ2 ☞ 58HRC~(Induction hardening)

Order Part Number — L — N — F — DK  
 GPSLOC 32 — 180 — N100  
 GPS-XLOC32 — 180 — N100 — F75 — DK32.025

Days to Ship **Quotation**

Alterations Part Number — L(LC) — N — F — DK — (MC-etc.)  
 GPS-XLOC32 — LC 179 — N100 — F75 — DK32.025 — MC

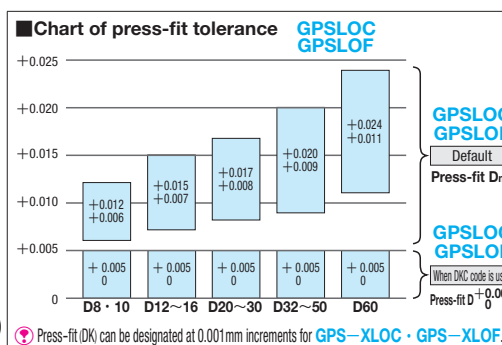

Alteration details ☞ P.879 • 880

Alterations	Code	Spec.	1Code															
	LC	Total length alteration LC=1mm increments Shortens the full length (L) as shown in the drawing. (Tip dimension E remains unchanged.) Ⓜ Lmin < LC < Lmax.	<b>Quotation</b>															
	MC	Tip tapping Ⓜ D=Not available for 8 and 10. <table border="1"> <thead> <tr> <th>D</th> <th>M×Pitch</th> <th>ℓ</th> </tr> </thead> <tbody> <tr> <td>12-13</td> <td>M 6×1.0</td> <td>12</td> </tr> <tr> <td>16</td> <td>M10×1.5</td> <td>20</td> </tr> <tr> <td>20</td> <td>M12×1.75</td> <td>24</td> </tr> <tr> <td>25~60</td> <td>M16×2.0</td> <td>32</td> </tr> </tbody> </table>		D	M×Pitch	ℓ	12-13	M 6×1.0	12	16	M10×1.5	20	20	M12×1.75	24	25~60	M16×2.0	32
D	M×Pitch	ℓ																
12-13	M 6×1.0	12																
16	M10×1.5	20																
20	M12×1.75	24																
25~60	M16×2.0	32																
	YC	Adds a stopper groove. Use this alteration when a tap cannot be used. Ⓜ D=Not available for 8~12.																
	DKC	Changes press-fit section tolerance. Dm5 → D +0.005 Ⓜ Available for GPSLOC, GPSLOF	<b>Quotation</b>															
	FC	Introduction recess processing Adds an introduction recess processing on the press-fit section. FC=1mm increments 3 ≤ FC ≤ N-10 Recess processing section D —0.01 —0.03																
	GA	Adds a tap to attach a leader assist pin. Ⓜ Available for D40/50/60. Alteration details ☞ P.879	<b>Quotation</b>															

Price **Quotation**

## GPSLOC • GPSLOF (Press-fit length designation type)

Part Number	L	N	F	U/Price	1~9				
Type	D	5mm increments	1mm increments	1mm increments	GPSLOC GPSLOF				
Spiral groove fixed length GPSLOC	8	40~70	0~40	GPSLOF F ≥ E+P and F ≤ L-N Ⓜ GPSLOC is no designation necessary for F	<b>Quotation</b>				
	10	40~70							
	12	40~110							
		115~160							
	13	115~160							
		165~200							
	16	40~110							
		115~160							
	20	165~200							
		40~110							
	Spiral groove length designation GPSLOF	25				50~110	0~100	GPSLOF F ≥ E+P and F ≤ L-N Ⓜ GPSLOC is no designation necessary for F	<b>Quotation</b>
						115~160			
165~200									
205~260									
60~100									
105~160									
165~200									
205~260									
70~100									
105~160									
165~200									
205~260									

Ⓜ Designate N=0 for GPSLOC • GPSLOF, when no press-fit part is required.

Ⓜ Please designate process-fit length with N ≤ L-F.

## GPS-XLOC • GPS-XLOF (Press-fit diameter • length designation type)

Part Number	L	N	F	Press-fit diameter DK	U/Price	1~9			
Type	D	5mm increments	1mm increments	1mm increments	0.001mm inc.	GPS-XLOC GPS-XLOF			
Spiral groove fixed length GPS-XLOC	8	40~70	5~40	GPS-XLOF F ≥ E+P and F ≤ L-N Ⓜ GPS-XLOC is no designation necessary for F	<b>Quotation</b>				
	10	40~70							
	12	40~110							
		115~160							
	13	115~160							
		165~200							
	16	40~110							
		115~160							
	20	165~200							
		40~110							
	Spiral groove length designation GPS-XLOF	25				50~110	5~100	GPS-XLOF F ≥ E+P and F ≤ L-N Ⓜ GPS-XLOC is no designation necessary for F	<b>Quotation</b>
						115~160			
165~200									
205~260									
60~110									
115~160									
165~200									
205~260									
70~110									
115~160									
165~200									
205~260									

Ⓜ DK tolerance of press-fit diameter of D8~30: DK ±0.002.

Ⓜ Please designate process-fit length with N ≤ L-F.

Ⓜ DK tolerance of press-fit diameter of D32~60: DK ±0.003.

Leader Components