

CARTRIDGE HEATERS

-OUTPUT SELECTION TYPE-

Refer to P.354 for new release lubricant seizure inhibitor

RoHS10

MCH

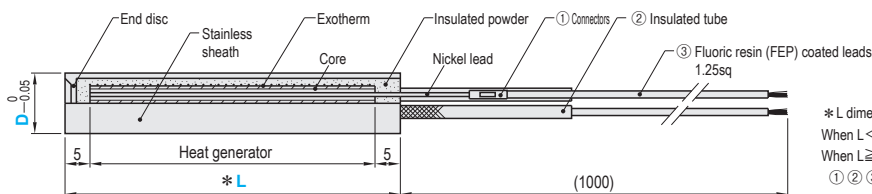

* L dimension and allowable curving
 When $L < 300$ 0.02 or less
 When $L \geq 300$ 0.05 or less
 ① ② ③ Heat resistance: 180°C or lower
 SUS304

V (Voltage)	W (Wattage)	W/cm ² (Watt density)	Part Number		D	L	Unit Price 1~9 pcs
			Type				
200	130	5.8	MCH		8	100	Quotation
	200	7.1				100	
	300	8.0				130	
	400	9.1				150	
	400	7.5				180	
	450	7.5				200	
	480	5.3			300		
	400	11.2			100		
	550	11.6			130		
	700	12.6			150		
	800	11.9			180		
	900	11.6			200		
	950	10.5			250		
	1200	10.5			300		
	400	5.7			150		
	550	6.4			180		
	650	6.8			200		
	750	6.2			250		
1000	6.9	300					

Coupling nipples...MCHB (D8~14) P.339



Order

Part Number — L
MCH 12.6 — 250



Days to Ship

Quotation



Price

Quotation



Example

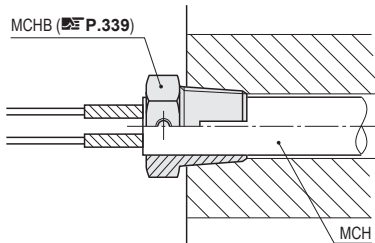

- Having a tapered thread that is slightly shallower than standard length, it enables fastening a cartridge heater easier by tightening.
 - If the tightening is weak, use M3 bolts to fix the heater bolt and heater firmly from the side surface.
- Do not use with a heater of watt density over 15W/cm².

COMPONENTS FOR MOLD COOLING AND TEMPERATURE CONTROLLING SYSTEMS