





TOOLS FOR COOLING CIRCUIT PLUG



JWPKS
Tool set
①~⑩

③ Tool for D6  RoHS10

④ Tool for D8 / 10 

⑤ Tool for D12 

Knob Stopper Scale pipe Tensile shaft

Part name	Quantity	Material
① Special packaging case (JWPKC)	1	PP, PE, Polyurethane
② Special wrench (JWPKW)	1	Aluminum die casting, SCM
③ D6 Tool (JWPK3)	1	Brass, S45C, SUM23
④ D8, 10 Tool (JWPK4)	1	
⑤ D12 Tool (JWPK6)	1	
⑥ JWPZ6	25	Aluminum alloy
⑦ JWPZ8	25	
⑧ JWPZ10	25	
⑨ JWPZ12	25	
⑩ Instruction manual	1	—

② Special wrench



RoHS10



Order

Part Number
JWPK3



Days to Ship

- ② JWPKW
- ③ JWPK3
- ④ JWPK4
- ⑤ JWPK6

Quotation

• JWPKS

Quotation

Part Number	Unit Price
①~⑩ JWPKS	Quotation
②・⑩ JWPKW	
③ JWPK3	
④ JWPK4	
⑤ JWPK6	

P

Price

Quotation

* For quantities not displayed here, refer to our MISUMI website for more information.

- Features**
- Matching to the diameter of water hole D=6, 8, 10 and 12 mm.
 - JWPKS tool set for Cooling Circuit Plug JWPZ (see Left page) is a special tool to fix JWPZ into the cooling hole.
 - Can fix the cooling circuit plug at any position by using scale value on the scale pipe and stopper.

■ Depth to Insert Cooling Circuit Plugs

Diameter of water pathway D	Max. depth Fmax. (*1)
6	150
8	200
10	200
12	250

(*1) Max. scale value on the scale pipe

- ex

Example
- a) Match up the suitable tool (JWPK) and special wrench to meet D dimensions of the cooling circuit plug.
 - b) Fix JWPZ at Part A. Close tightly to the end part of scale pipe.
 - c) Move the stopper on the scale pipe to the position F to fix the cooling circuit plug.
 - d) Load the scale pipe into the mold cooling hole and put stopper on the mold side surface.
 - e) Grasp the handle with both hands to keep the scale pipe from tilting against the mold cooling hole.
 - f) Tensile shaft slides back and cooling circuit plug profile changes.
 - g) Verify that the cooling circuit plug is not moving and remove it from the tensile shaft by turning the shaft knob.

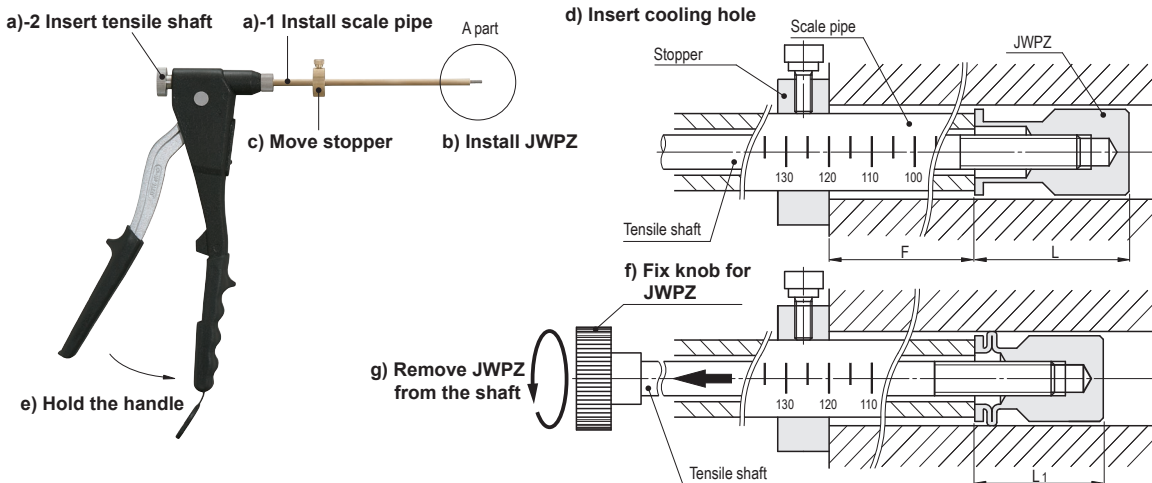

- Features**
- If you mount the cooling circuit plug, the special tool set and single parts for combination, JWPKW+JWPK3, 4, or 6 are available.
 - During mold maintenance or when the fixing location is set in the wrong position, remove the cooling circuit plug by drilling a hole and replace with a new cooling circuit plug.

MOLD MAINTENANCE RELATED PRODUCTS